



WL-240BF
ASSEMBLY MANUAL

Ver.2308



CAUTION

This manual has been prepared for workshop personnel expert in the use of the lift (operator) and technicians responsible for routine maintenance (Maintenance fitter).

This manual must be read with User's Manual.

The lifting, transport, unpacking, assembly, installation, starting up, initial adjustment and testing, extraordinary maintenance, repair, overhauls, transport and dismantling of the lift must be performed by specialized personnel from the licensed dealer or a service center authorized by the manufacturer.

ALL PACKING, LIFTING, HANDLING, TRANSPORT AND UNPACKING OPERATIONS ARE TO BE PERFORMED EXCLUSIVELY BY EXPERT PERSONNEL.

SKILLED AND AUTHORIZED PERSONNEL ONLY SHOULD BE ALLOWED TO PERFORM THESE OPERATIONS, FOLLOW ALL INSTRUCTIONS SHOWN BELOW CAREFULLY, IN ORDER TO PREVENT POSSIBLE DAMAGE TO THE CAR LIFT OR RISK OF INJURY TO PEOPLE. BE SURE THAT THE OPERATING AREA IS CLEARED OF PEOPLE.

Step 1

Be sure to take a complete inventory of parts prior to beginning installation.

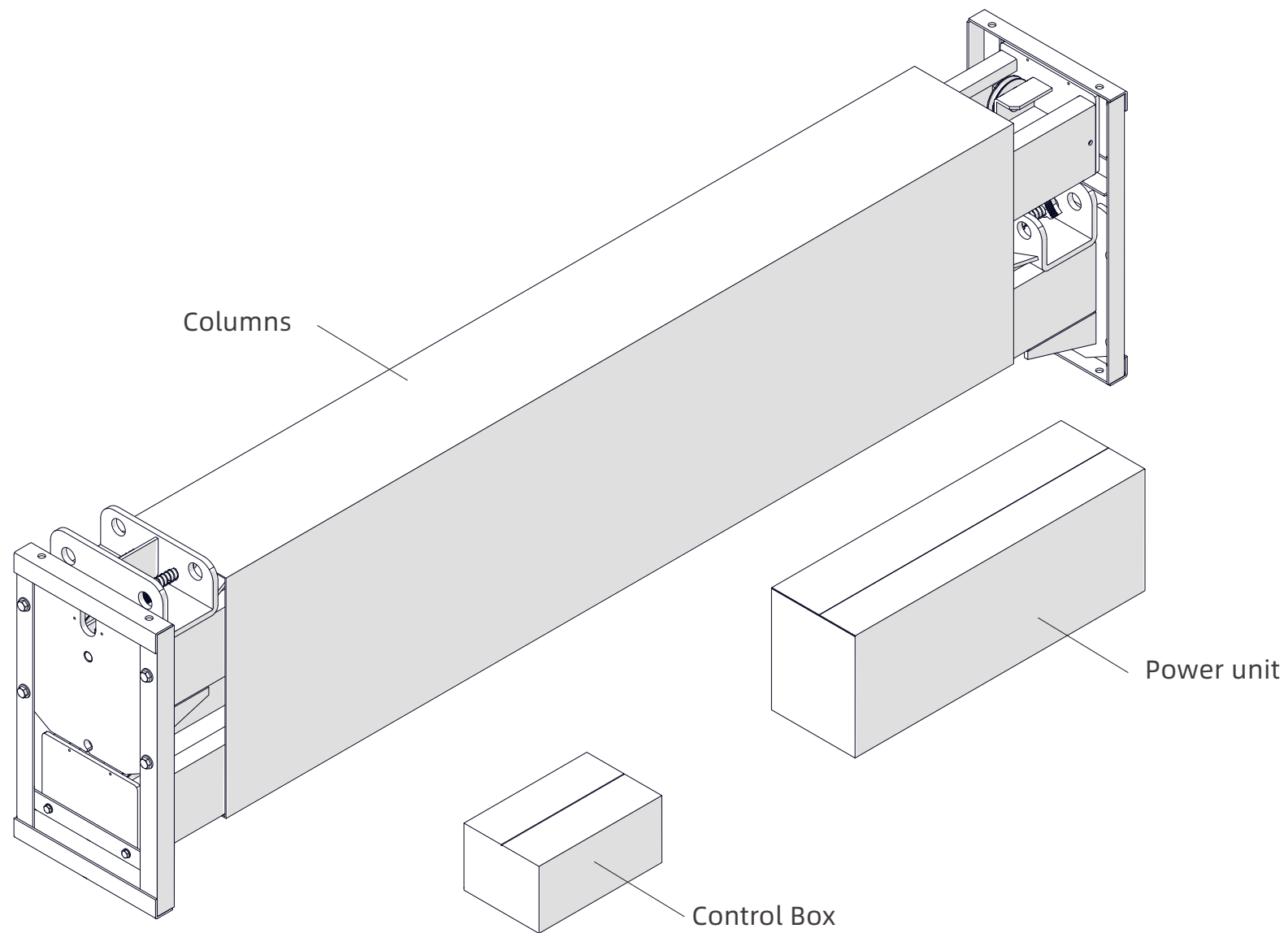

Step 2

To remove fixing bolts of packing brackets.

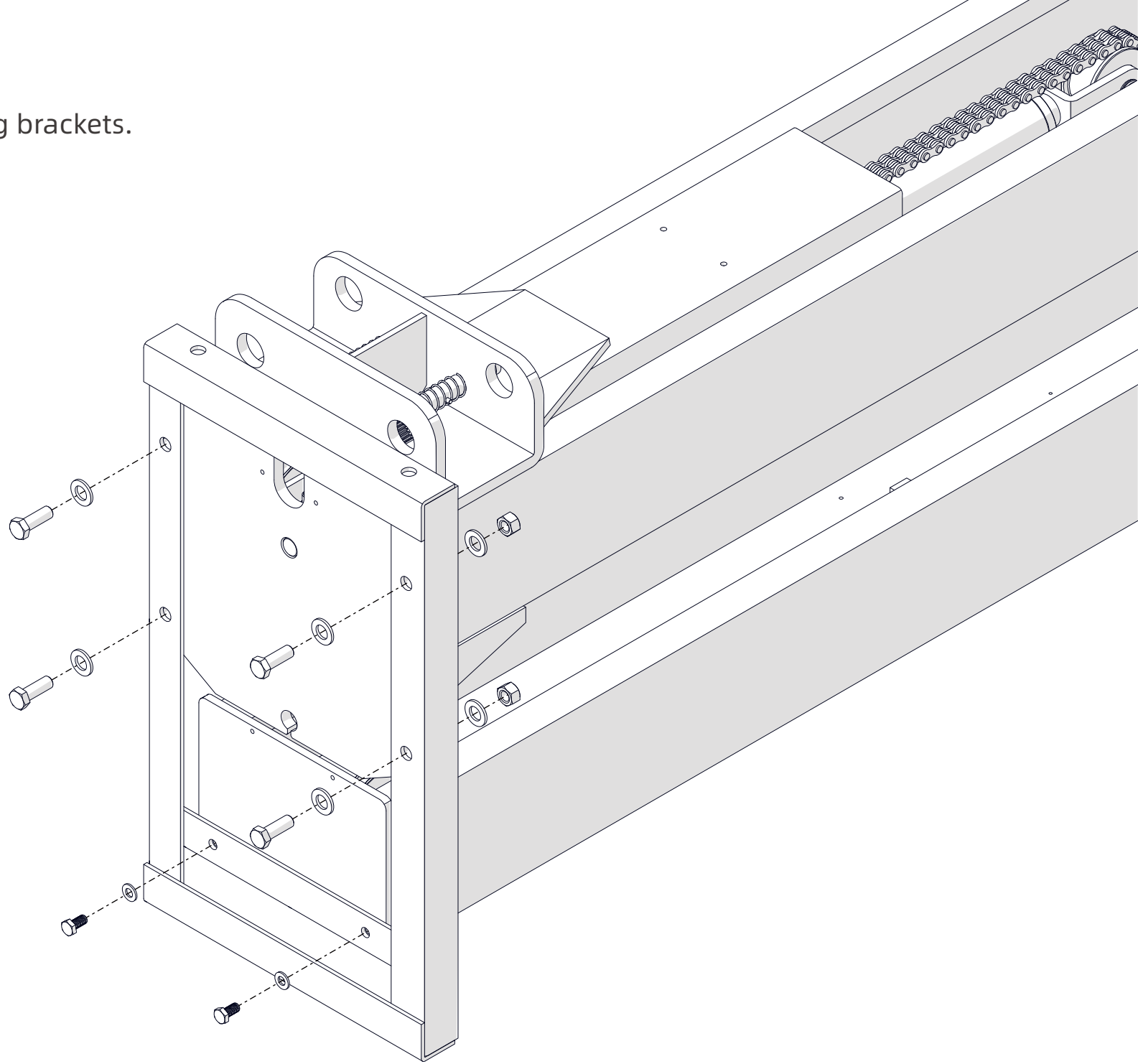

Step 3

To disassembly the package and remove all components and accessories.

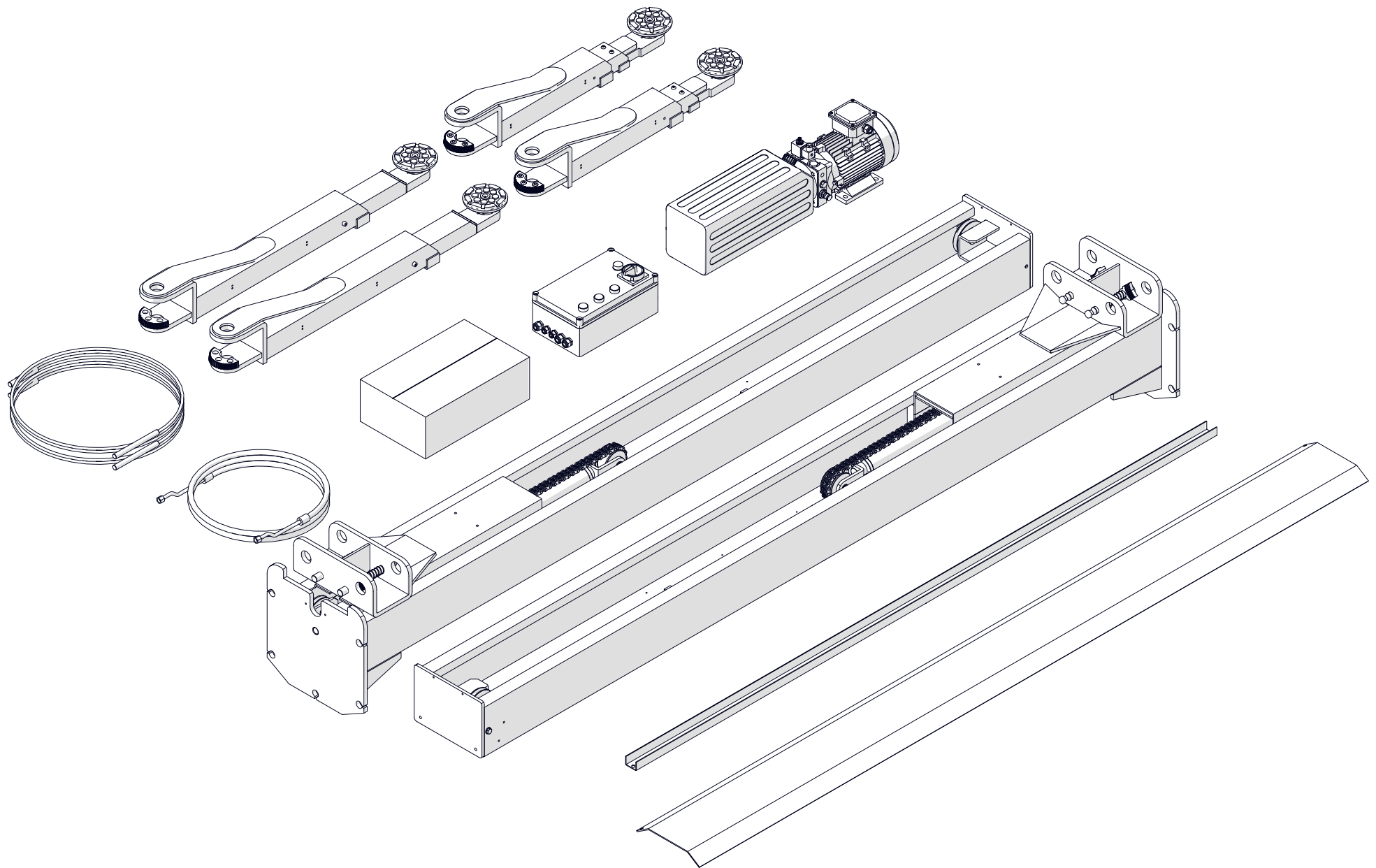

Step 4

- 1. To move two columns to install area.
- 2. Pay attention: to recognize and main column and slave column position to install.
- 3. To lift up two columns.
- 4. To measure the distance of two columns, and two columns face each other accurately.

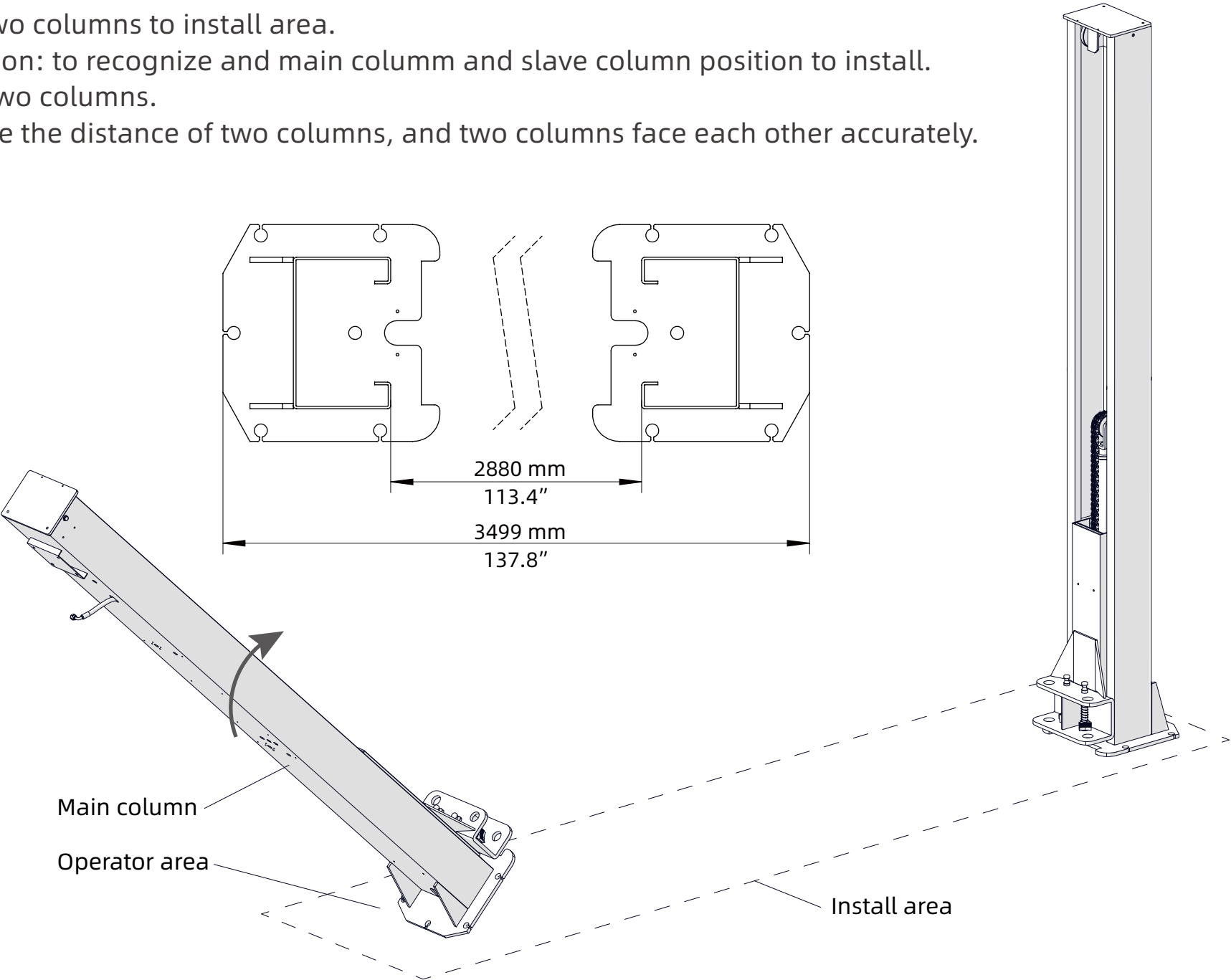

Step 5

1. Percussion drilling chopping bit 18.5mm depth 150mm.
2. Air purge to remove dust inside of hole.
3. Insert bolt with bushes and screw nut, not to tighten to death, insert U shape washer under the column baseplate to adjust, by aid of spirit level measurement to make column to be vertical at 90.
4. Insert bolt with hammer to hit in to the end.
5. Use the sleeve to tighten the nut

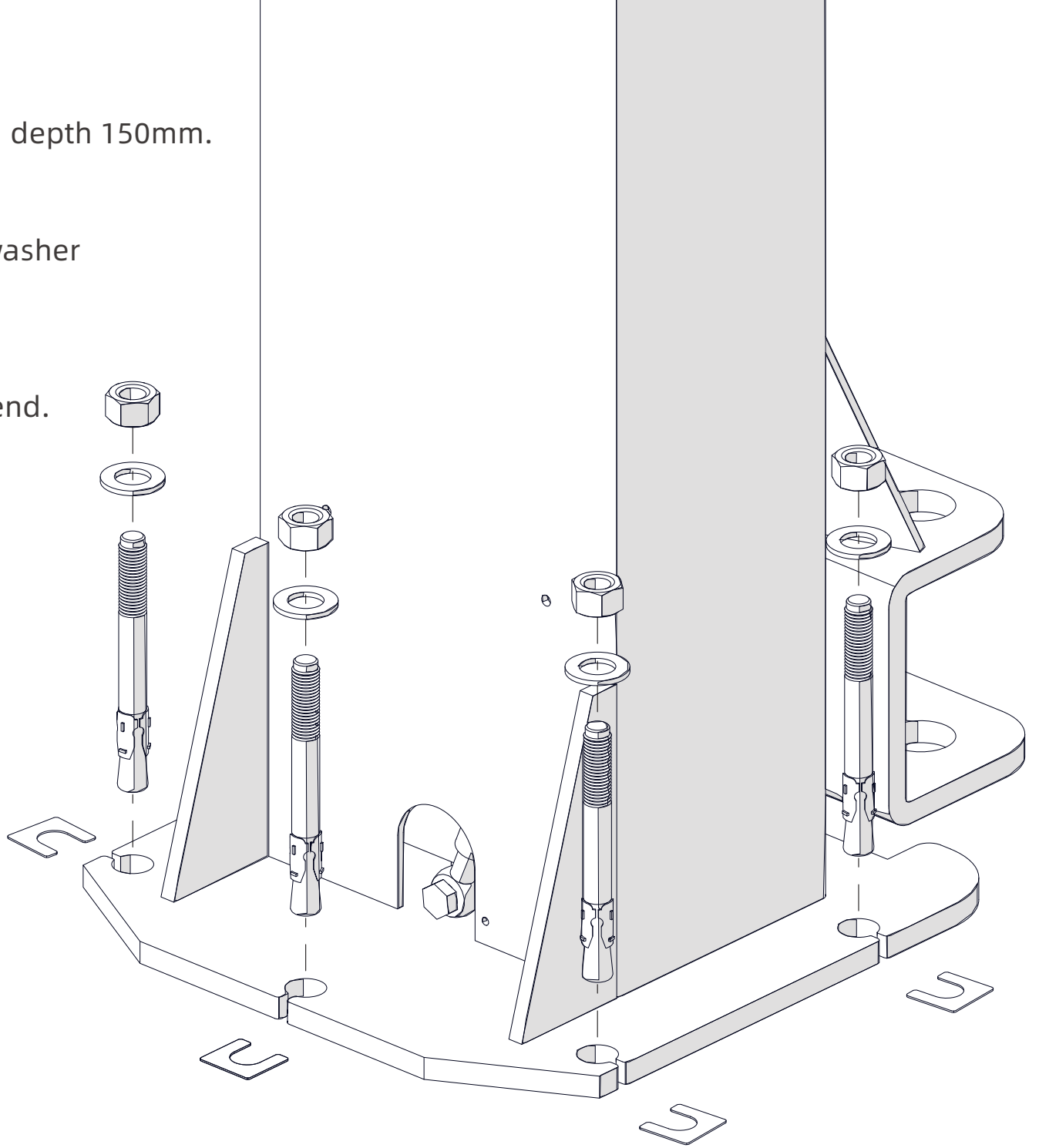

Step 6

To install the unlocking electromagnet and the lock plate.

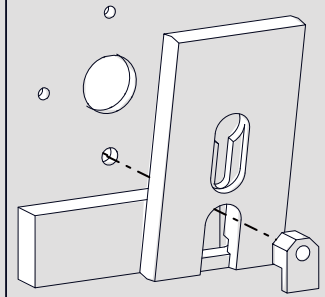
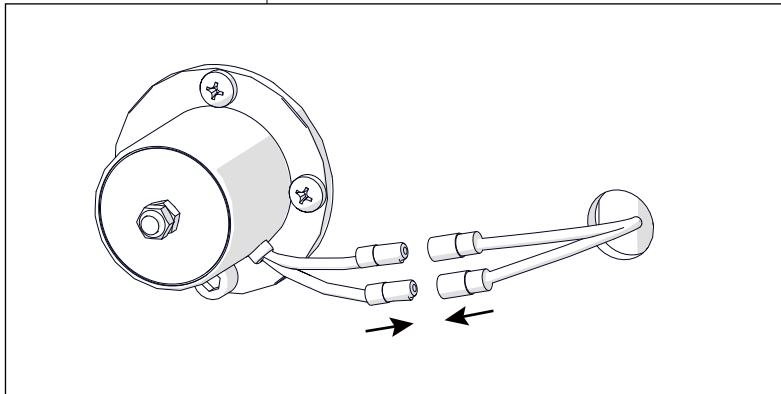
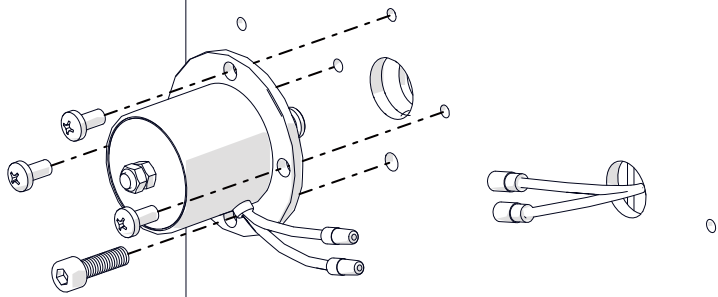

Step 7

To lift up the carriage to the first latch.

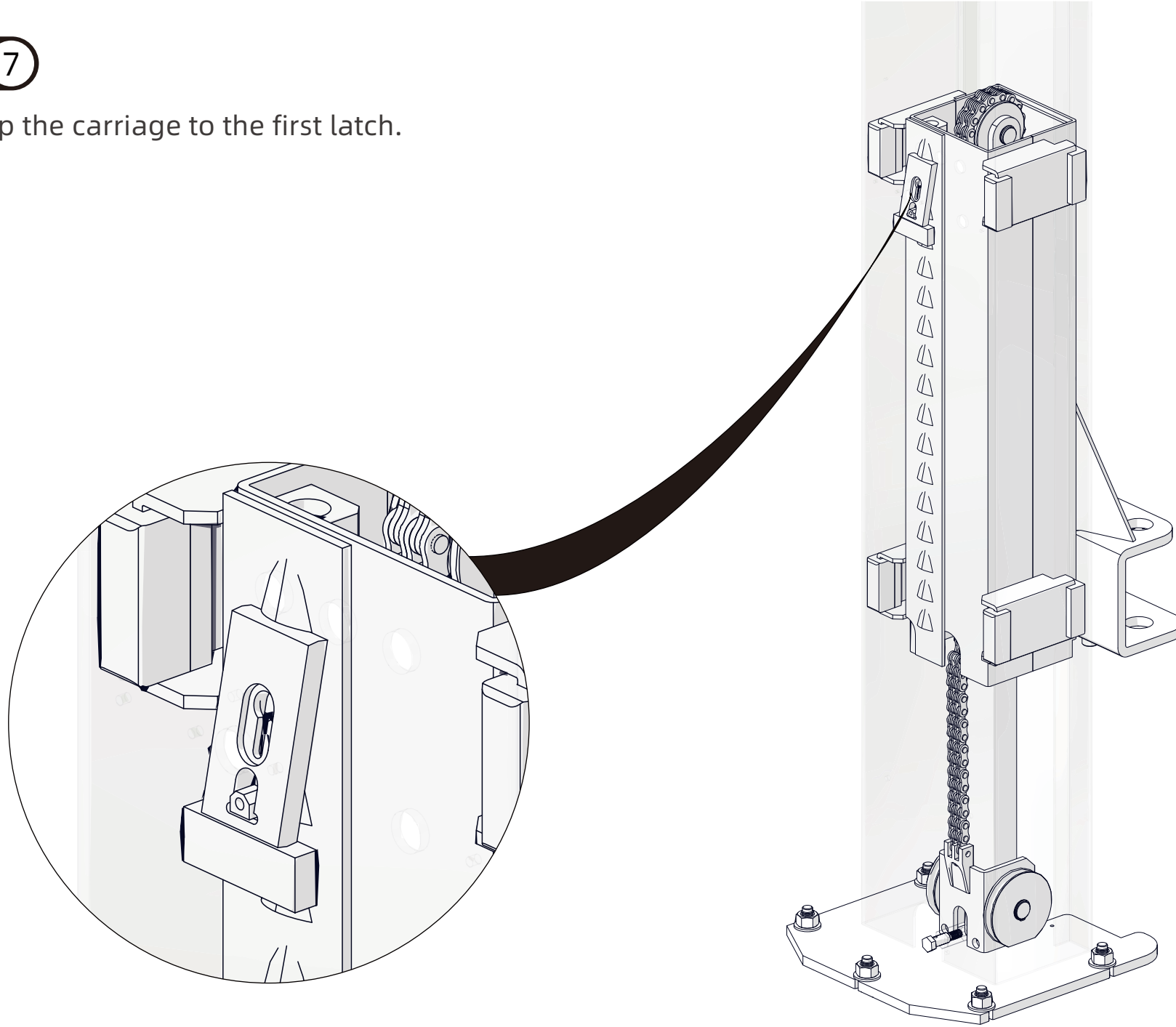

Step 8

To install the synchronization cables.

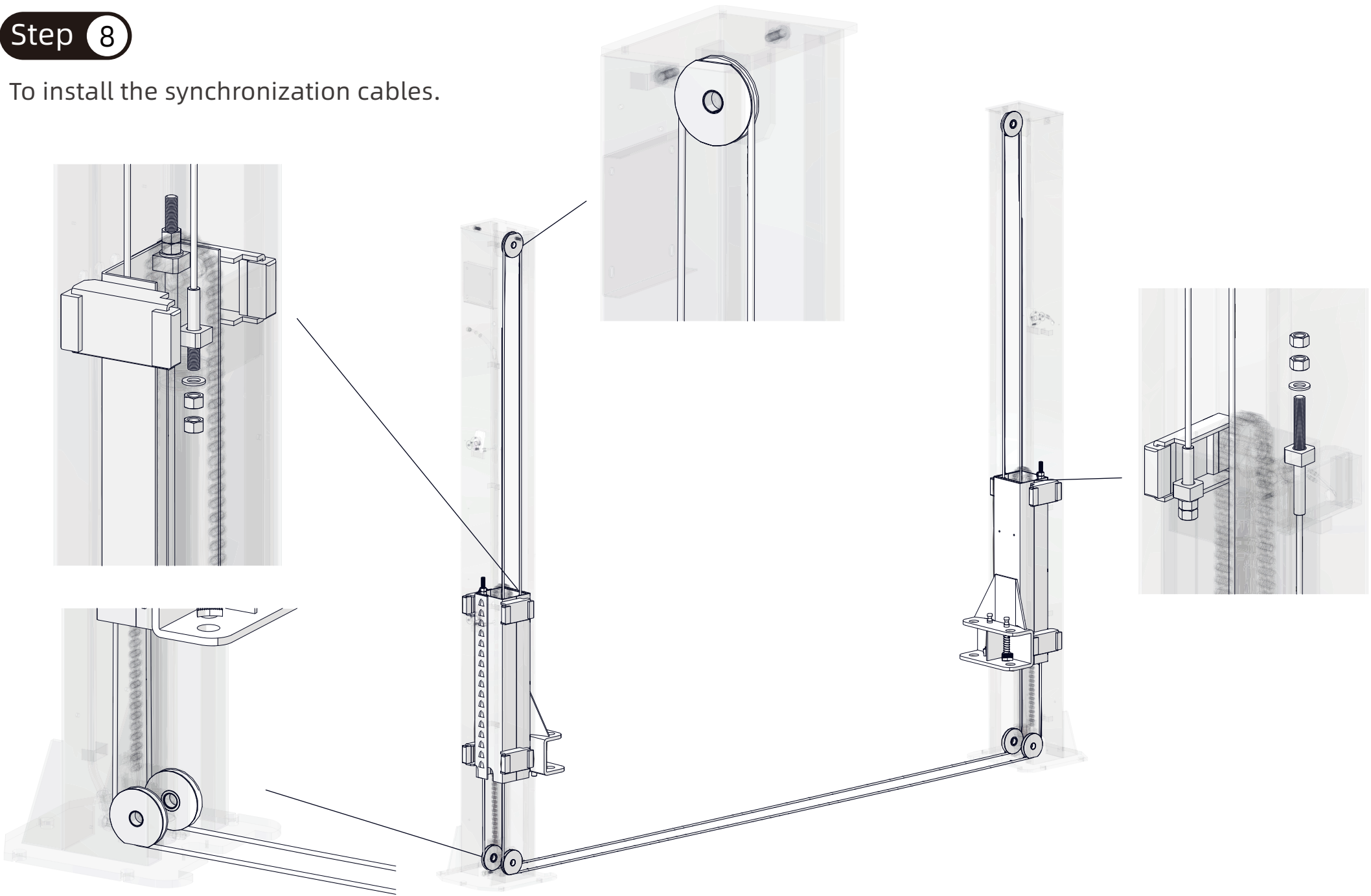

Step 9

To install power unit on column and link the oil hoses.

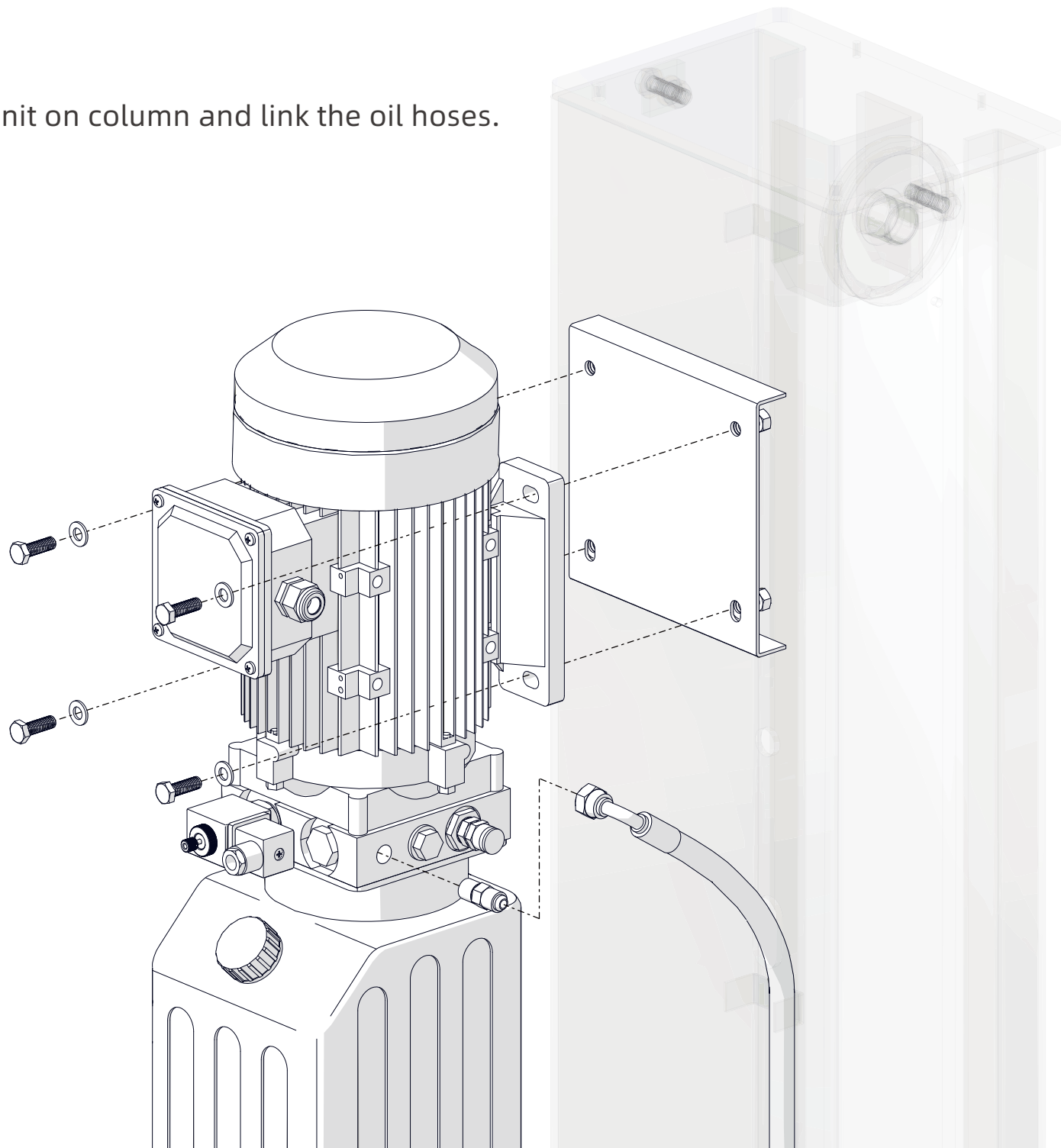

Step 10

Place the U-shaped hose protection plate and connect the oil hoses to the two cylinders.

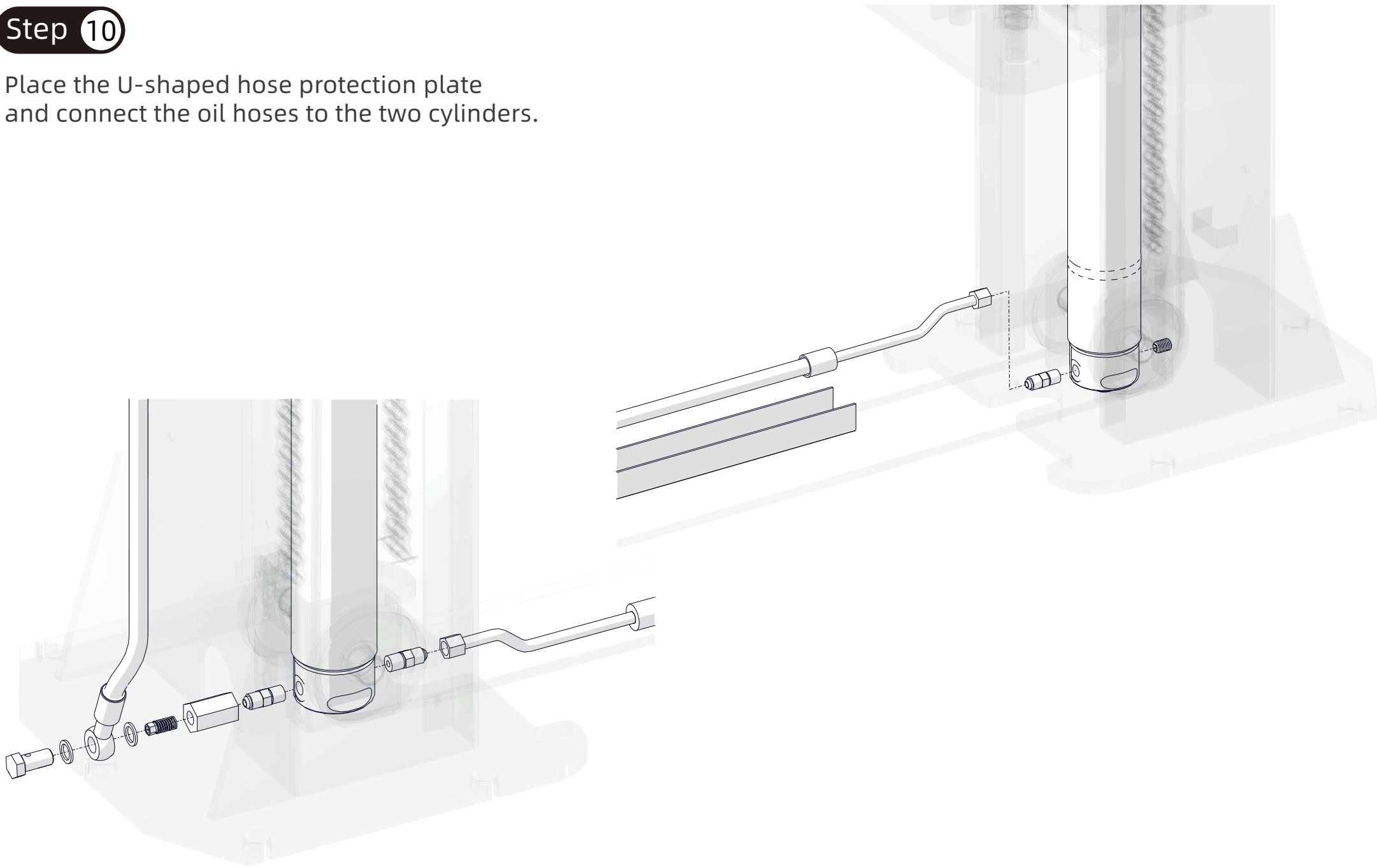

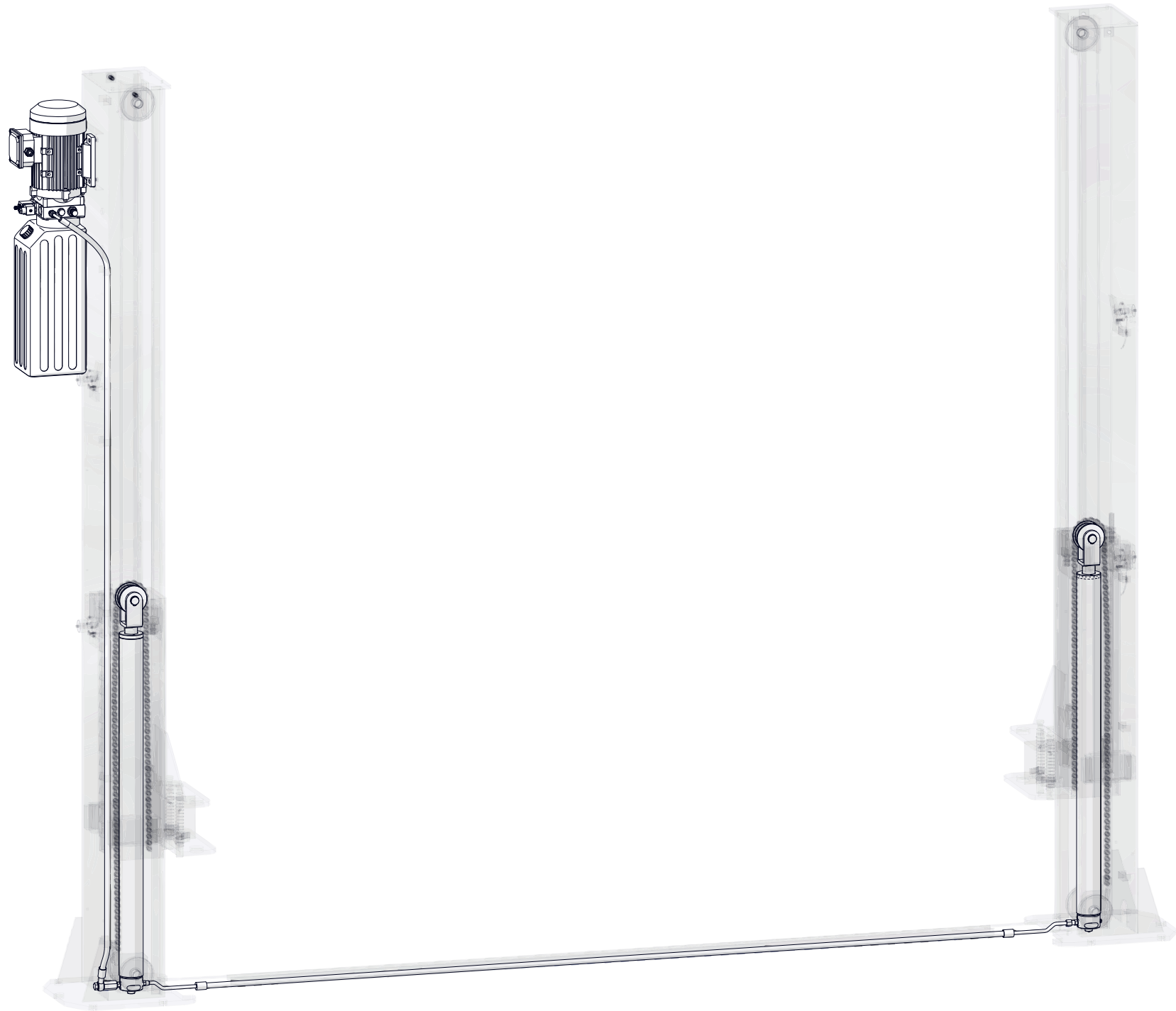

Step 11

To install the control box on column.

Connect the two wires of unlocking electromagnet into control box. No. 10,10

Connect the wires of solenoid valve into control box. No. 11,11

Connect the wires of up limit switch into control box. No. 4,5

Connect the wires of power unit into control box. No. U ,V ,W

Connect the wires of power line into control box. No. L1,L2,L3

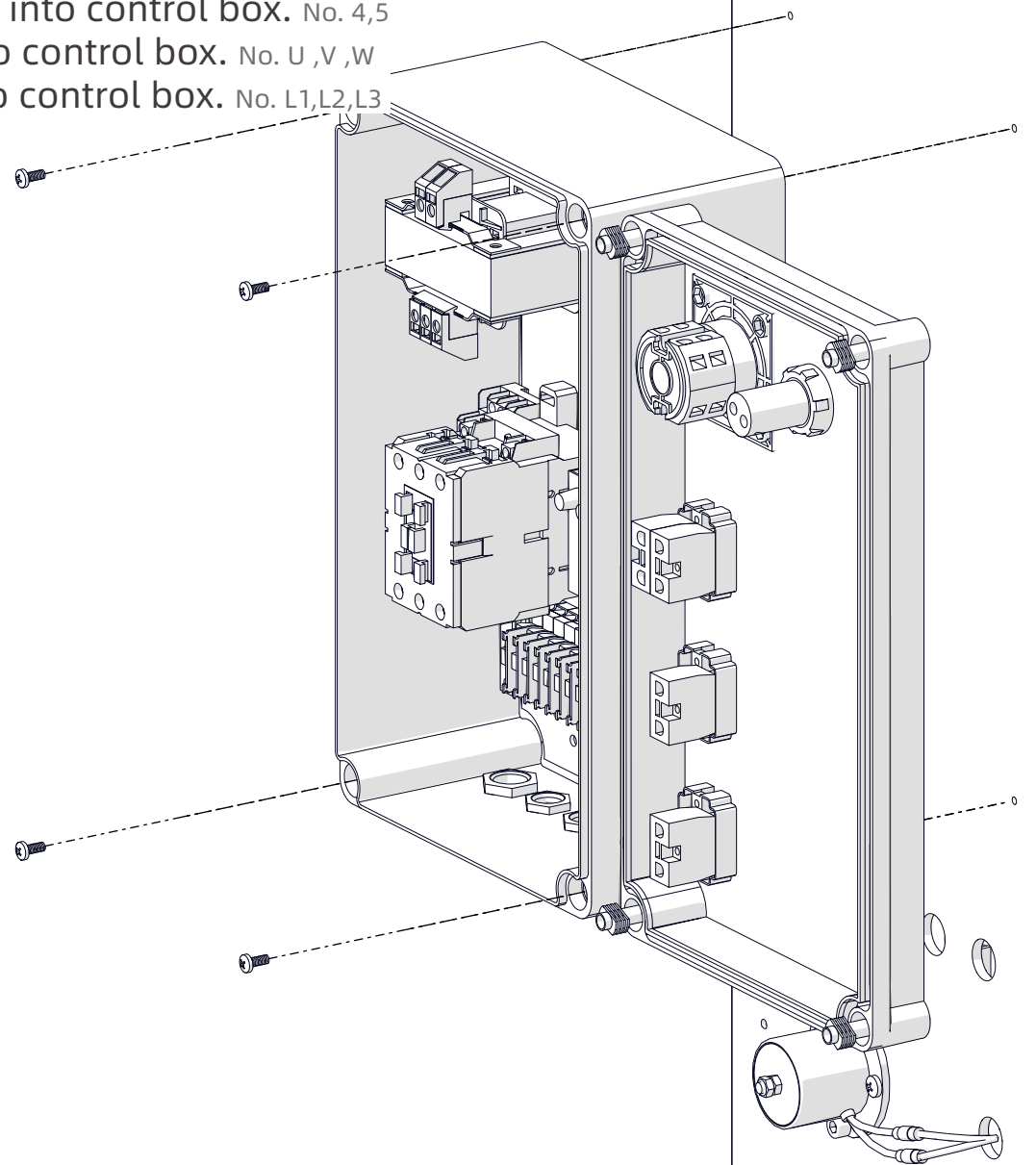

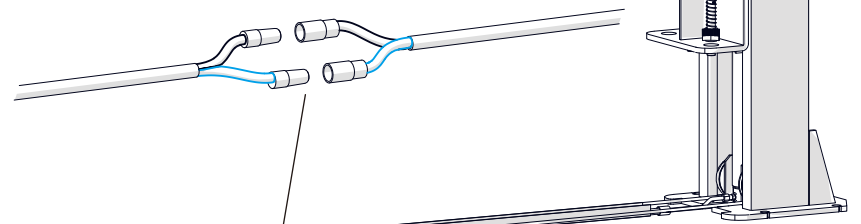
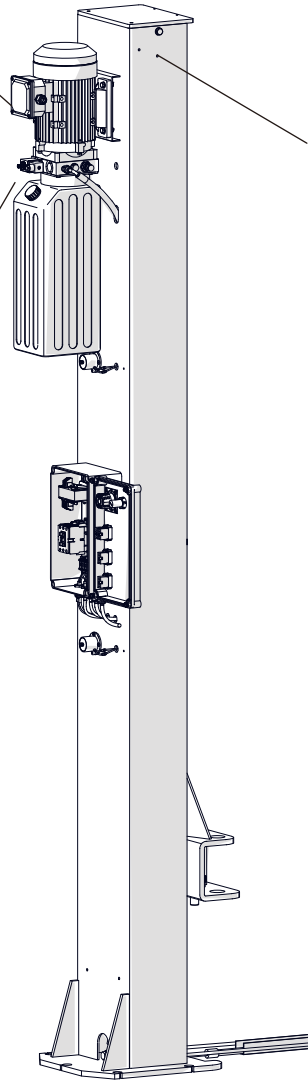
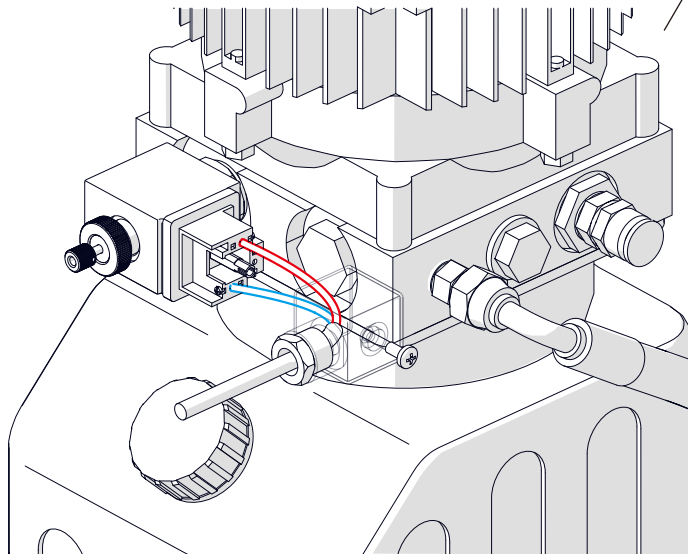
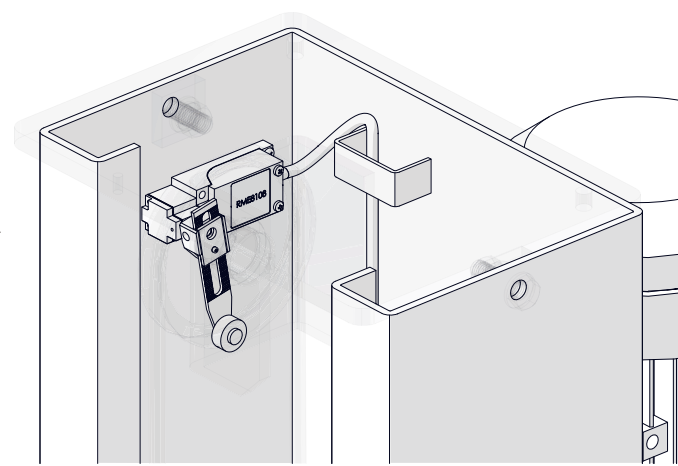
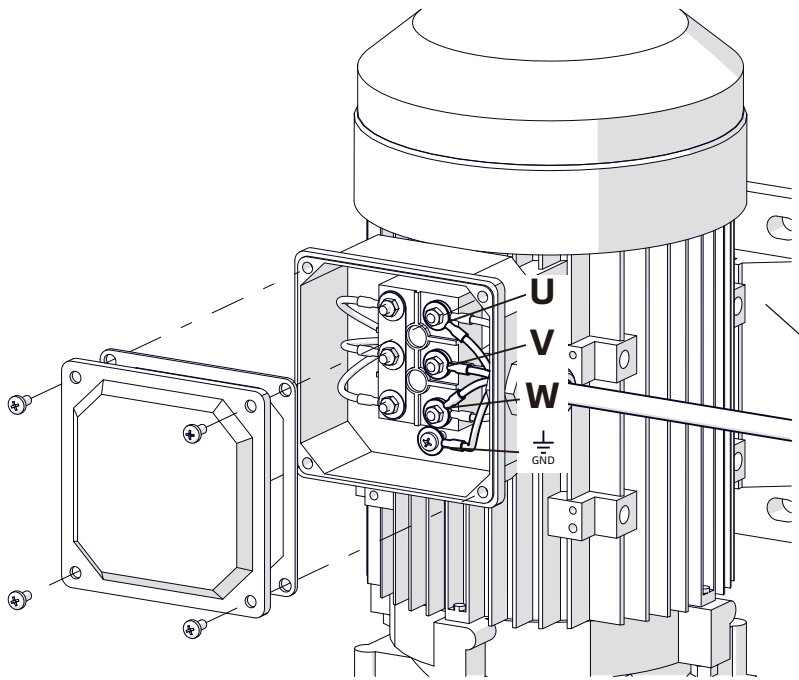

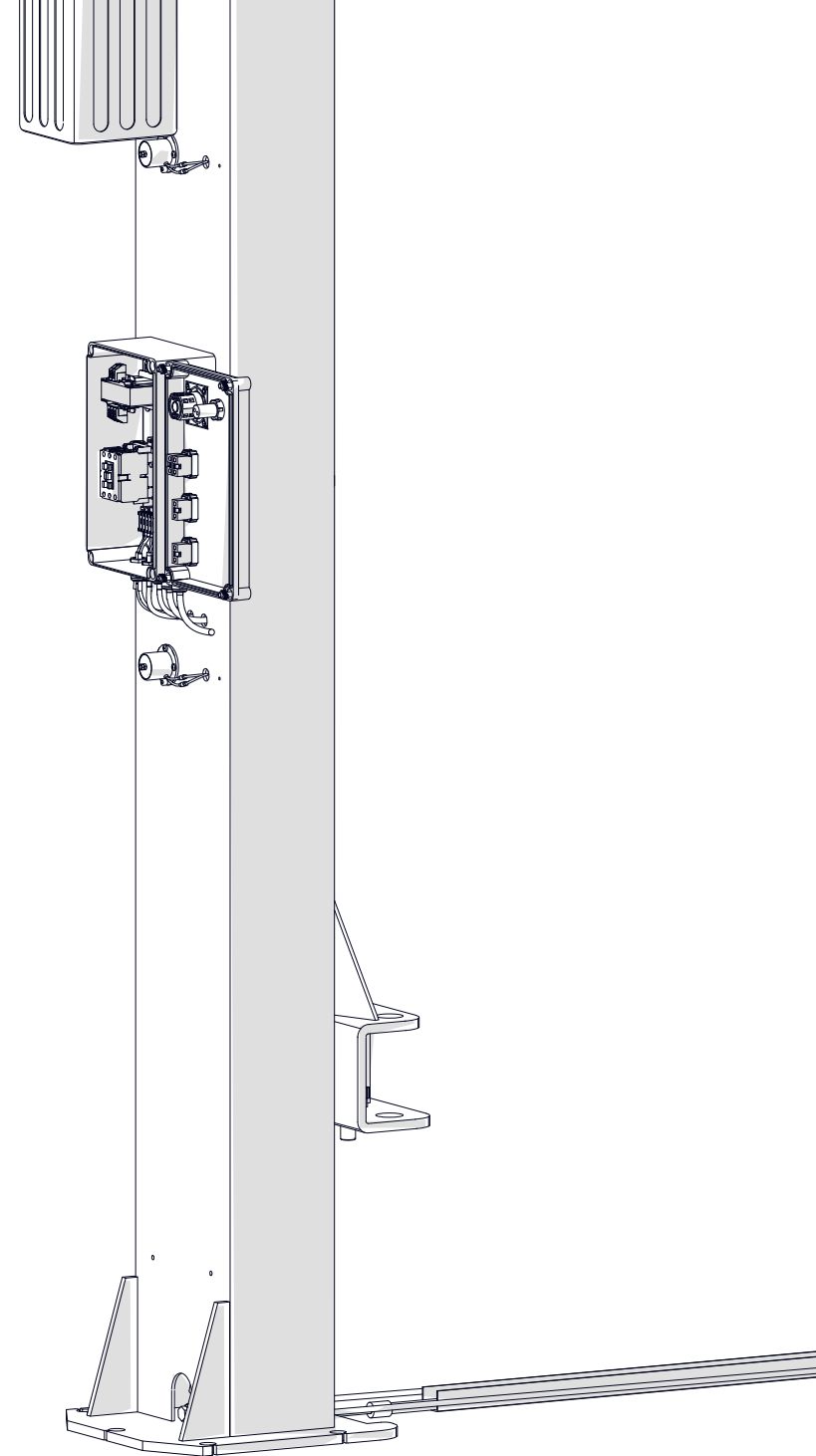
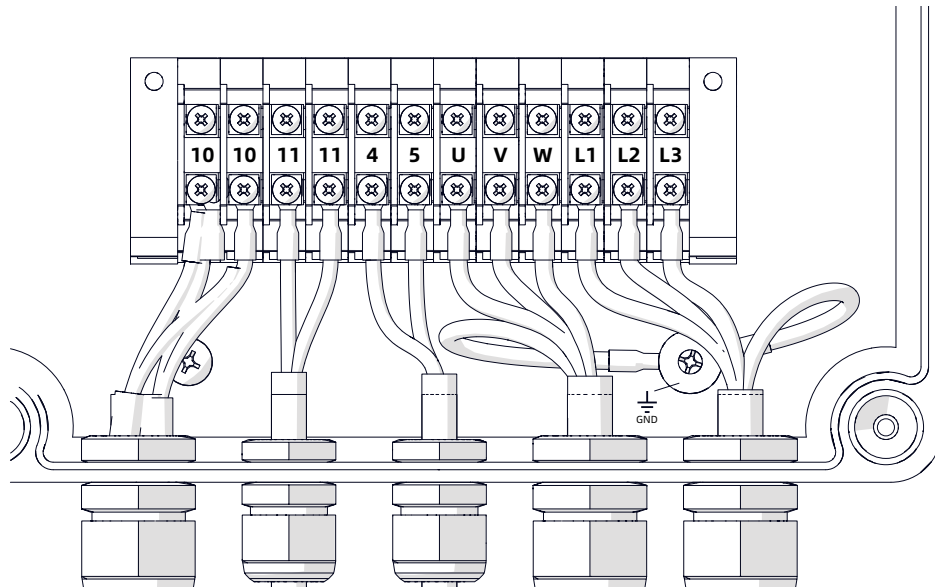
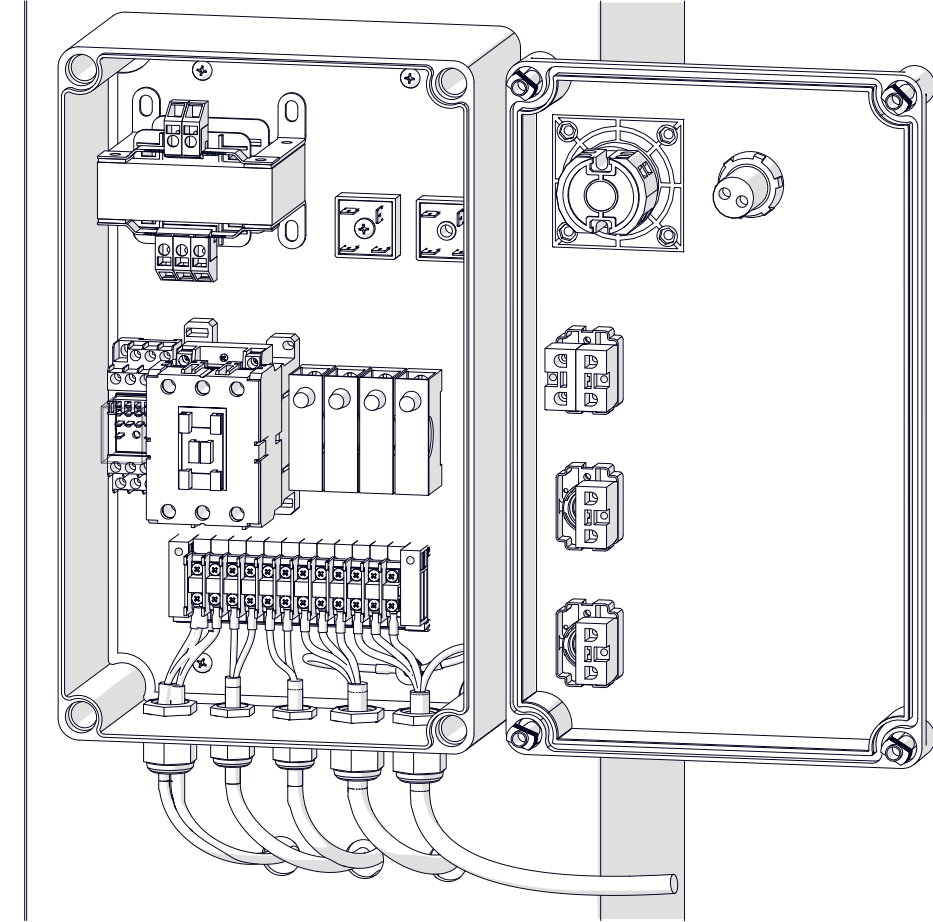

Step 12

To install arms and foot protector.

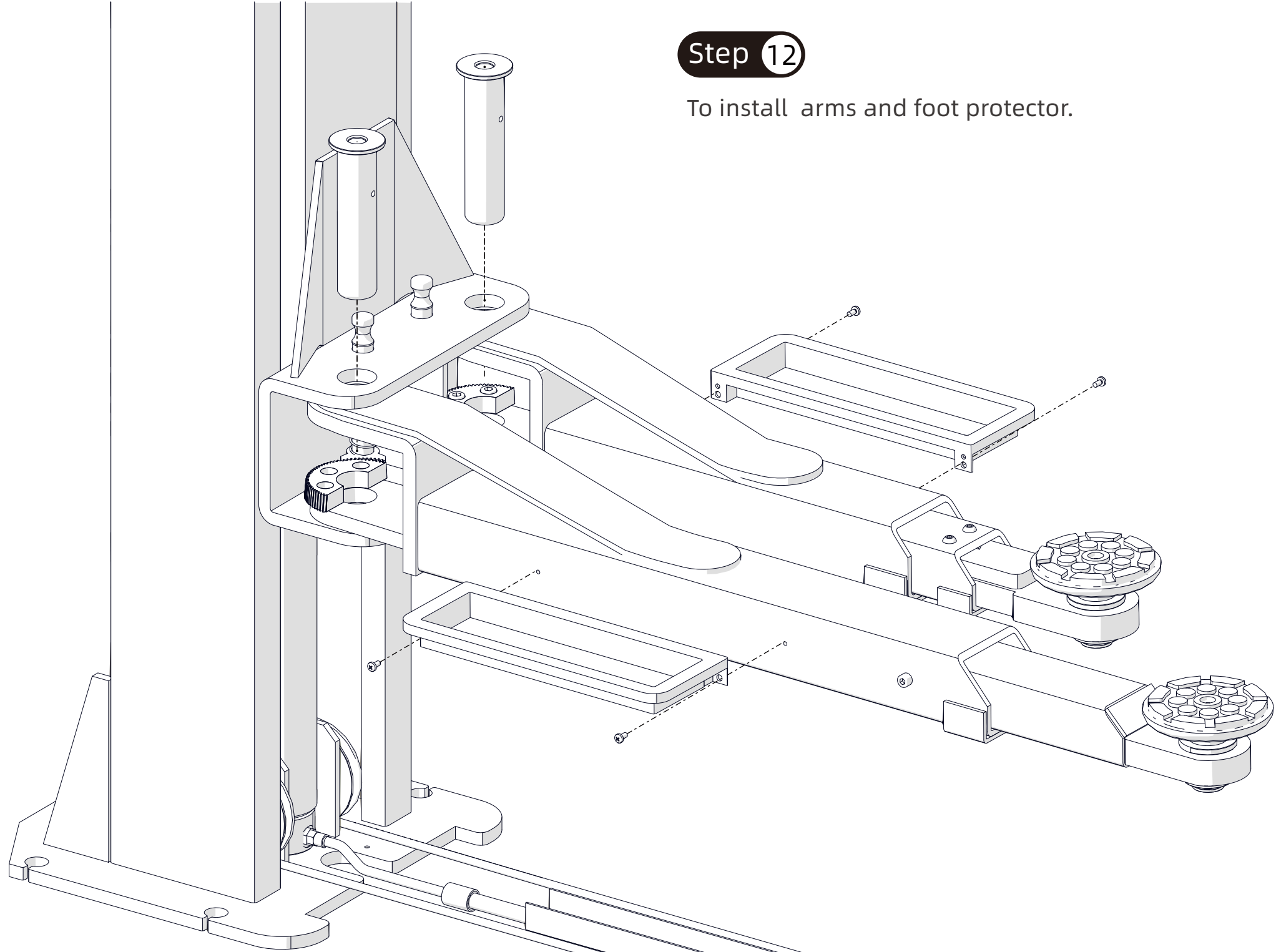

Step 13

To install columns curtain.

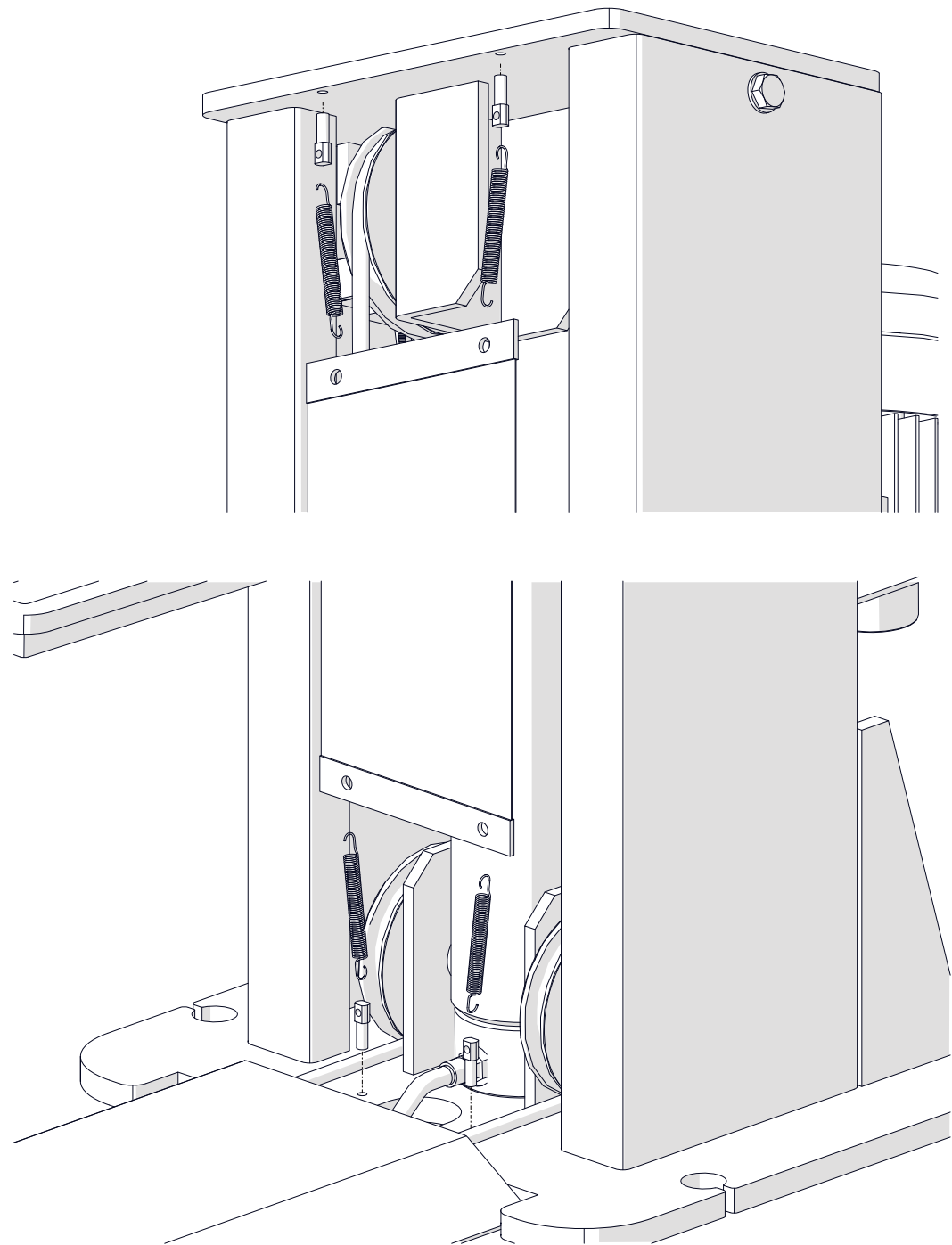
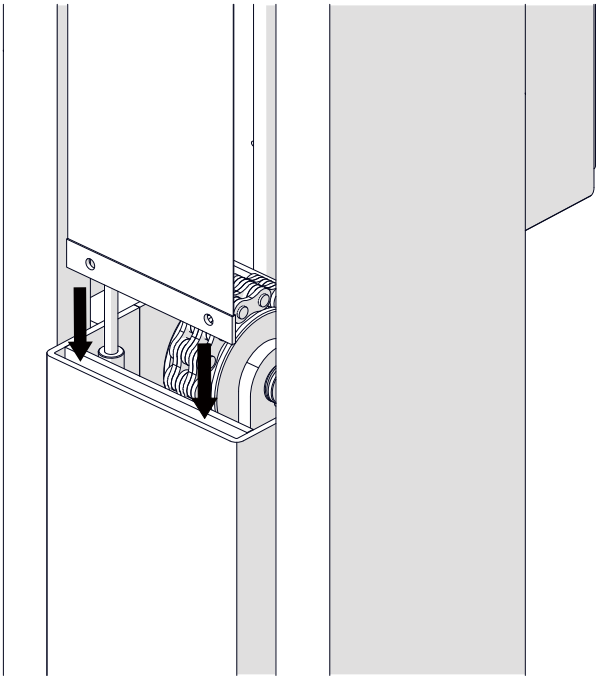

Step 14

To install electromagnets cover and SUV adapter bracket.

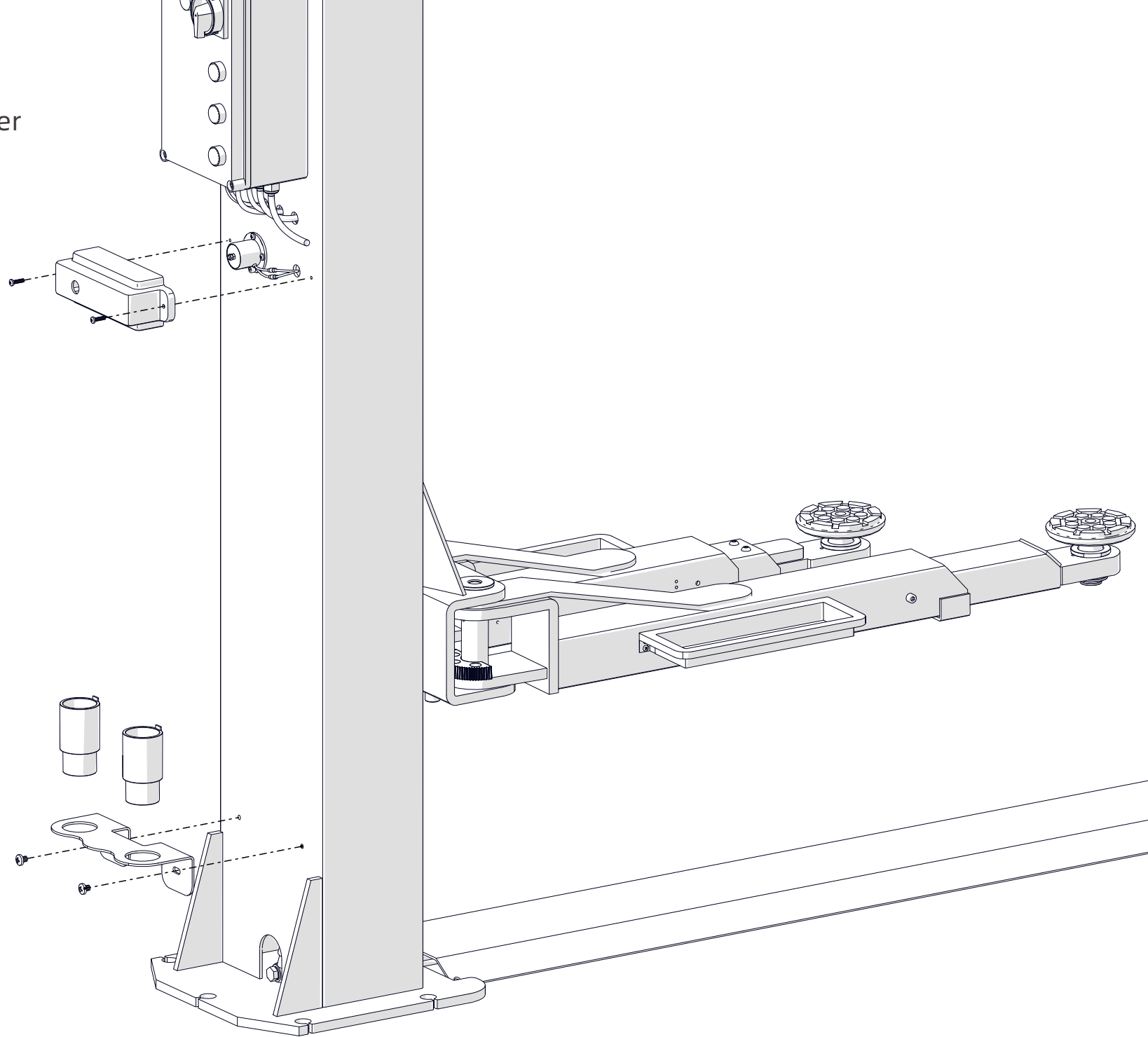

WOLF TOOLS