



ELECTRO-HYDRAULIC 2-POST LIFT

L-2140B ASSEMBLY MANUAL

Ver.210114.1



CAUTION

This manual has been prepared for workshop personnel expert in the use of the lift (operator) and technicians responsible for routine maintenance (Maintenance fitter).

This manual must be read with User's Manual.

The lifting, transport, unpacking, assembly, installation, starting up, initial adjustment and testing, extraordinary maintenance, repair, overhauls, transport and dismantling of the lift must be performed by specialized personnel from the licensed dealer or a service center authorized by the manufacturer.

ALL PACKING, LIFTING, HANDLING, TRANSPORT AND UNPACKING OPERATIONS ARE TO BE PERFORMED EXCLUSIVELY BY EXPERT PERSONNEL.

SKILLED AND AUTHORIZED PERSONNEL ONLY SHOULD BE ALLOWED TO PERFORM THESE OPERATIONS, FOLLOW ALL INSTRUCTIONS SHOWN BELOW CAREFULLY, IN ORDER TO PREVENT POSSIBLE DAMAGE TO THE CAR LIFT OR RISK OF INJURY TO PEOPLE. BE SURE THAT THE OPERATING AREA IS CLEARED OF PEOPLE.

Step 1

To disassembly the package and remove all components and accessories.

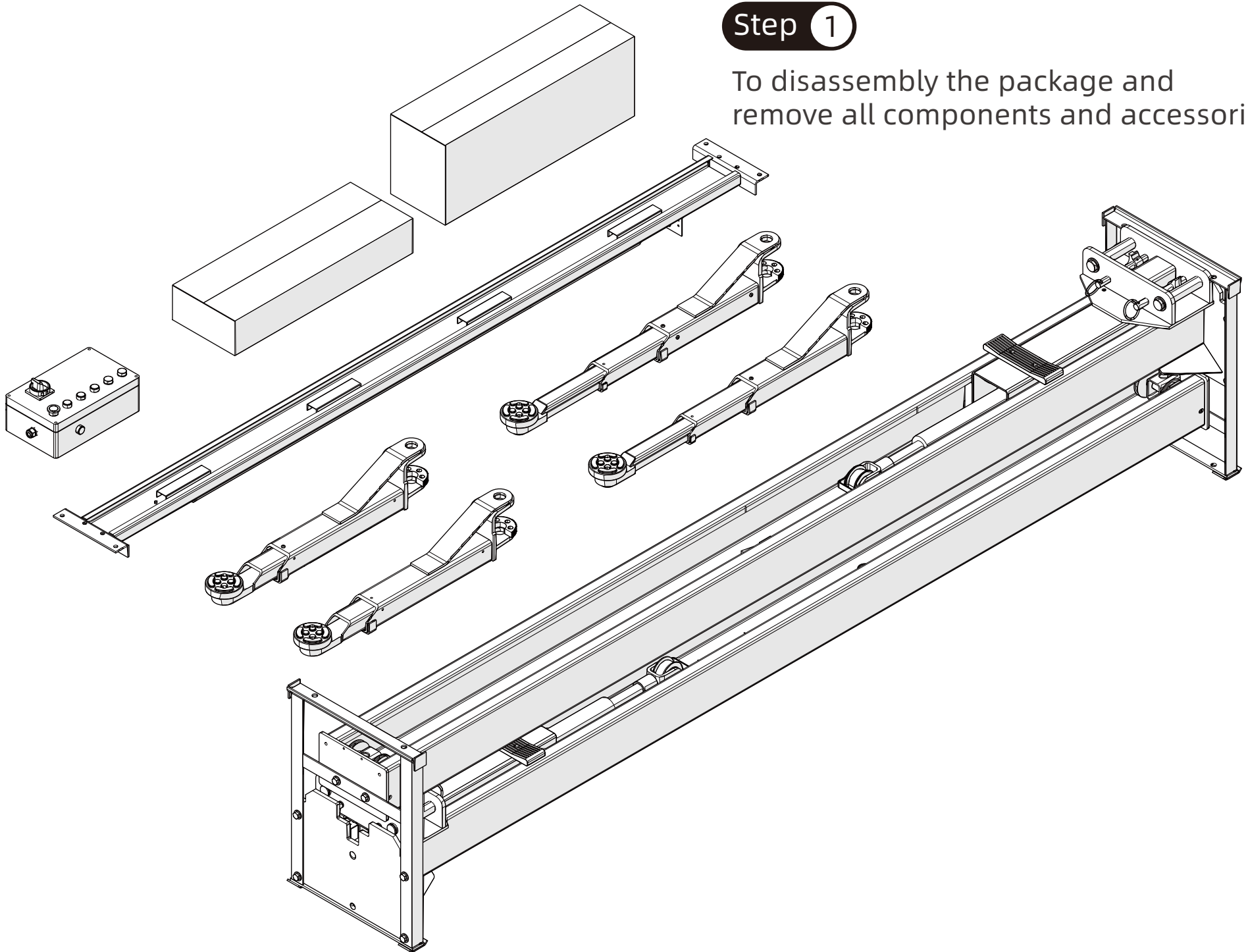

Step 2

To remove fixing bolts of packing brackets.

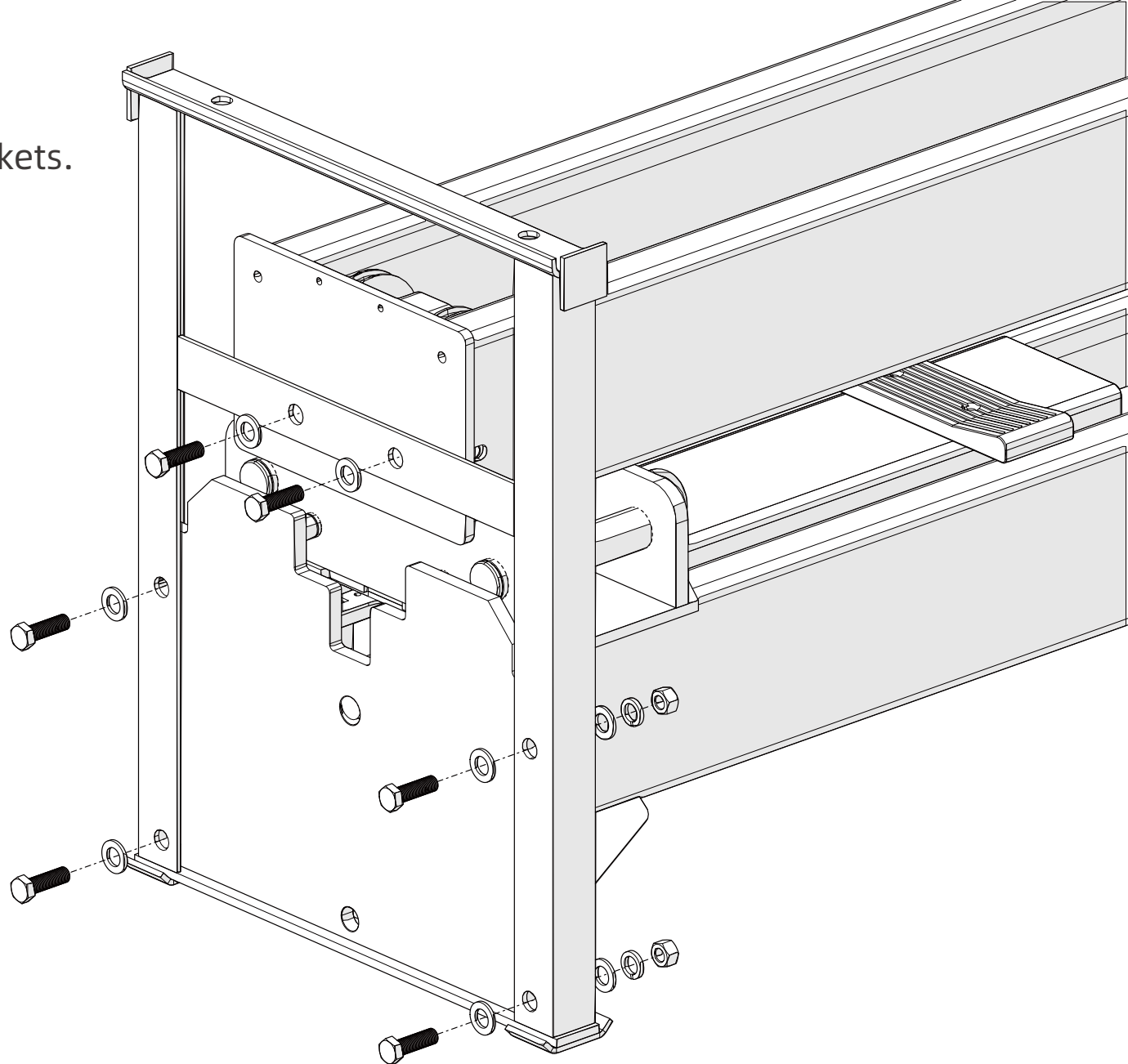

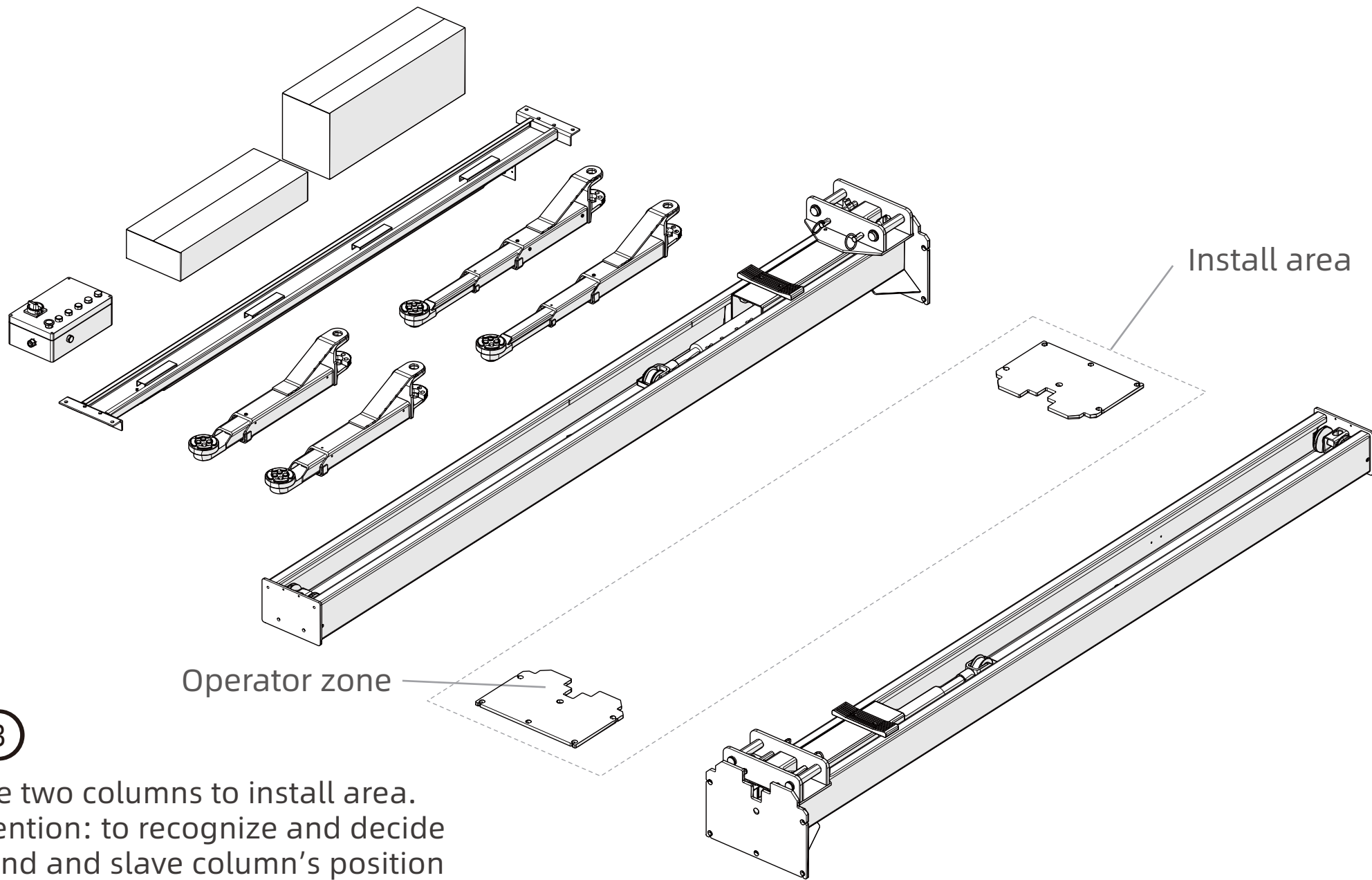

Operator zone

Install area

Step 3

To move two columns to install area.
Pay attention: to recognize and decide
command and slave column's position
to install.

Step 4

To lift up two columns.

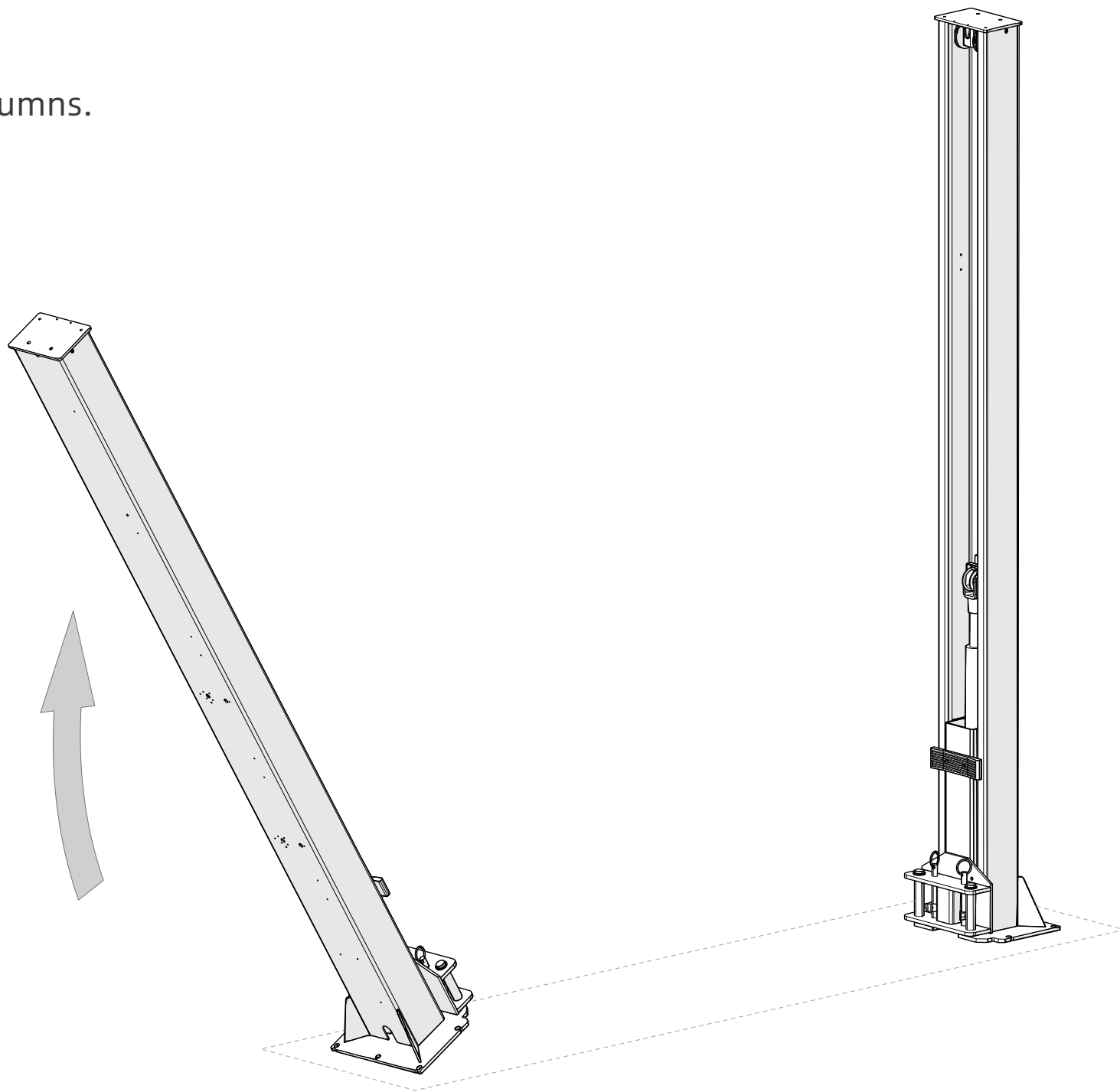

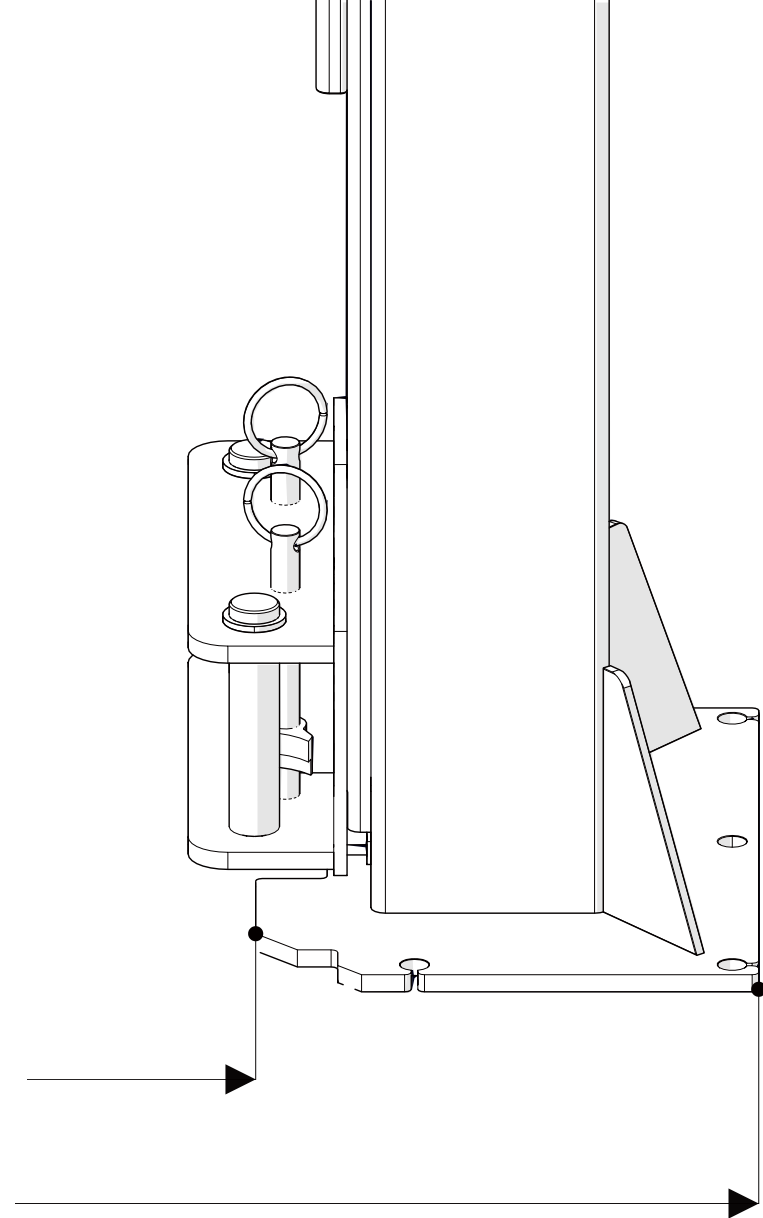
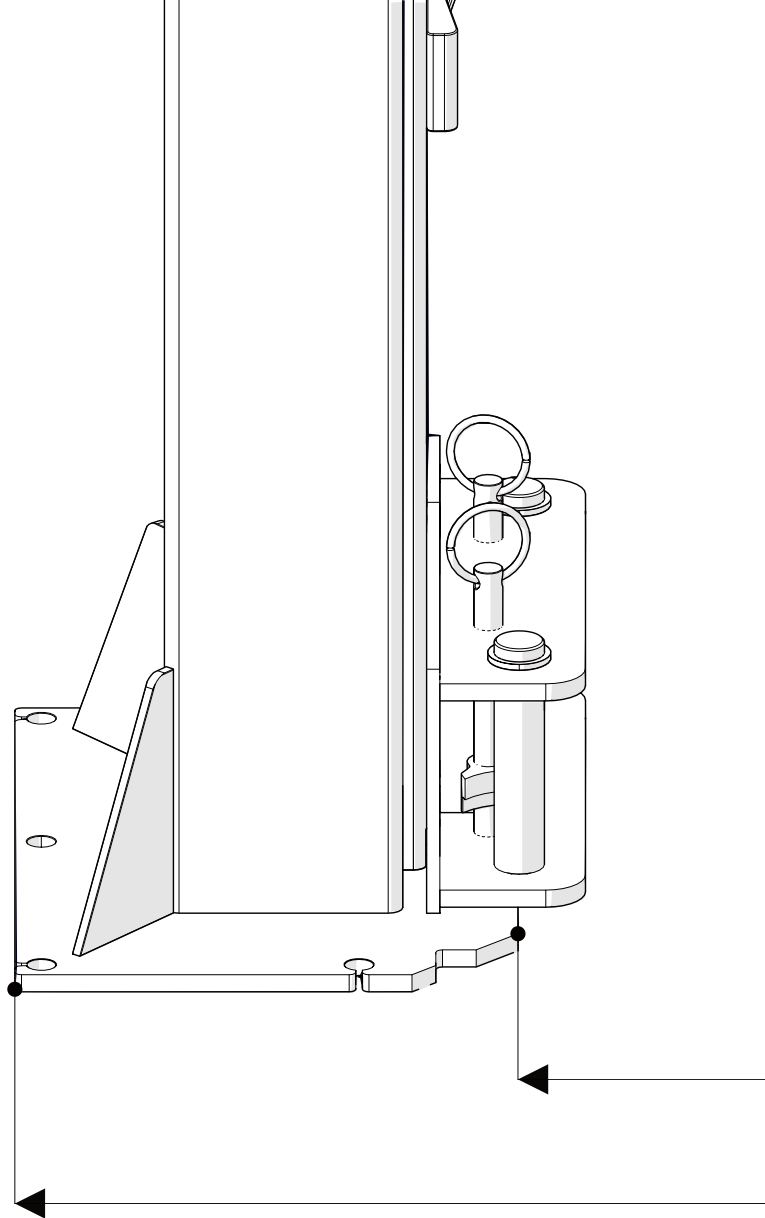

Step 5

Voor de afstand tussen de palen gebruikt u de bovenligger als vaste maat. Eerst de paal met de bediening zuiver waterpas stellen, vervolgens de 2e paal los plaatsen en de bovenligger monteren. Hierna kunt u de 2e paal waterpas stellen en dan pas vastboren..

Step 6

1. Percussion drilling chopping bit 18.5mm depth 150mm.
2. Air purge to remove dust inside of hole.
3. Insert bolt with bushes and screw nut, not to tighten to death, insert bushes under the column baseplate to adjust, by aid of spirit level measurement to make column to be vertical at 90°.
4. Insert long pin with hammer to hit in to the end.

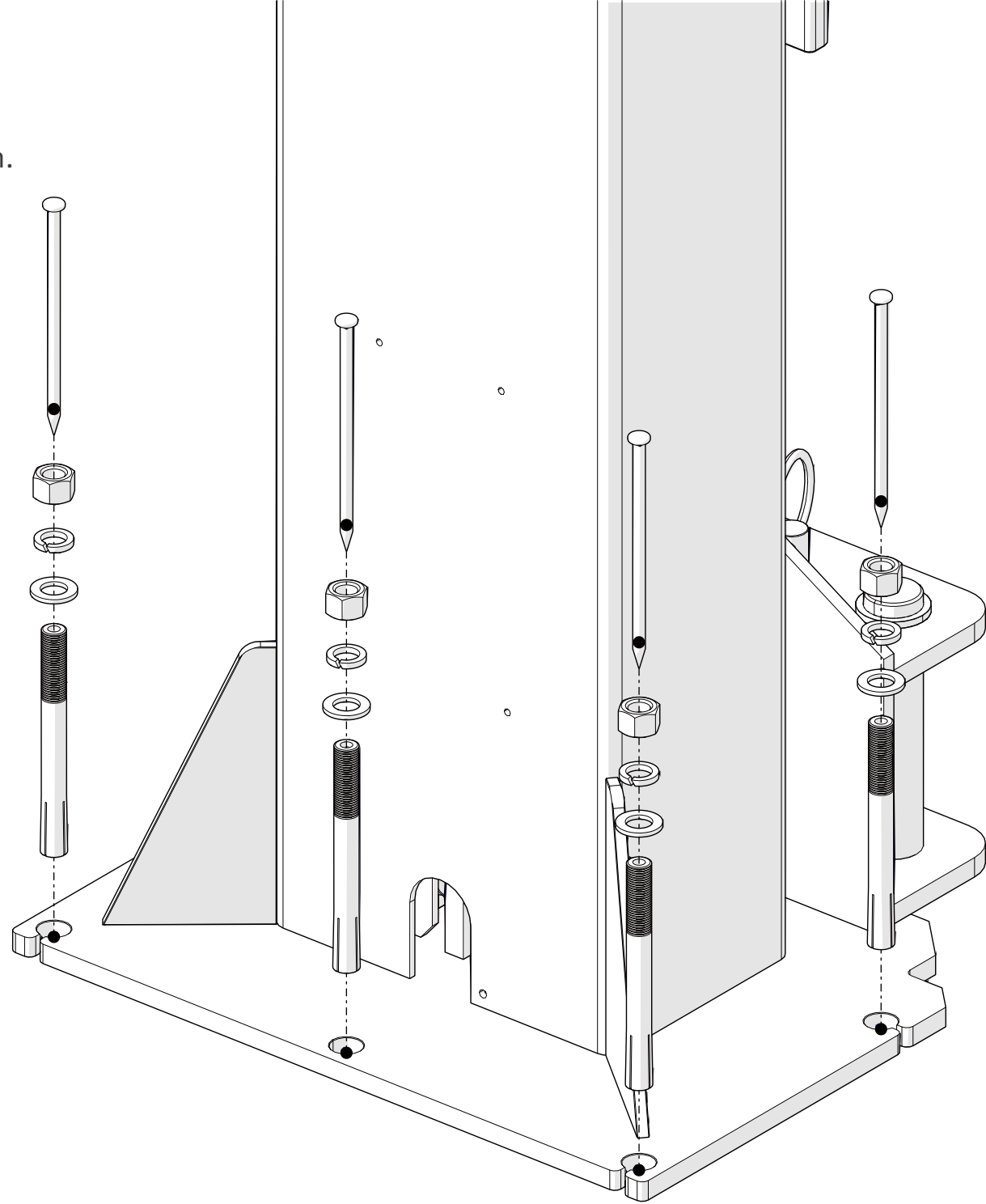

Step 7

To install the unlocking electromagnet and the lock plate.

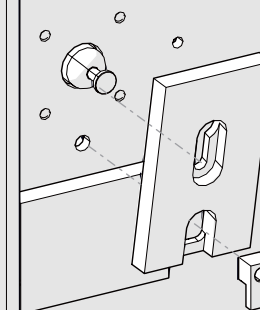
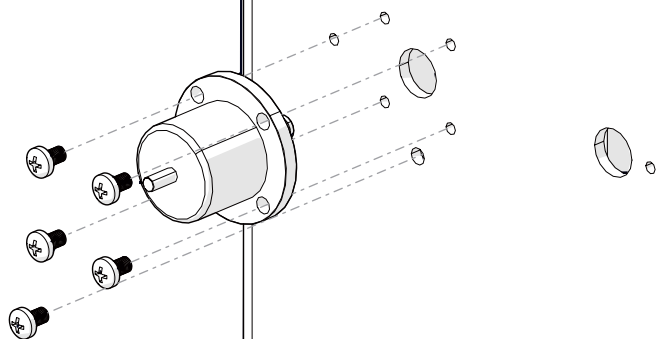

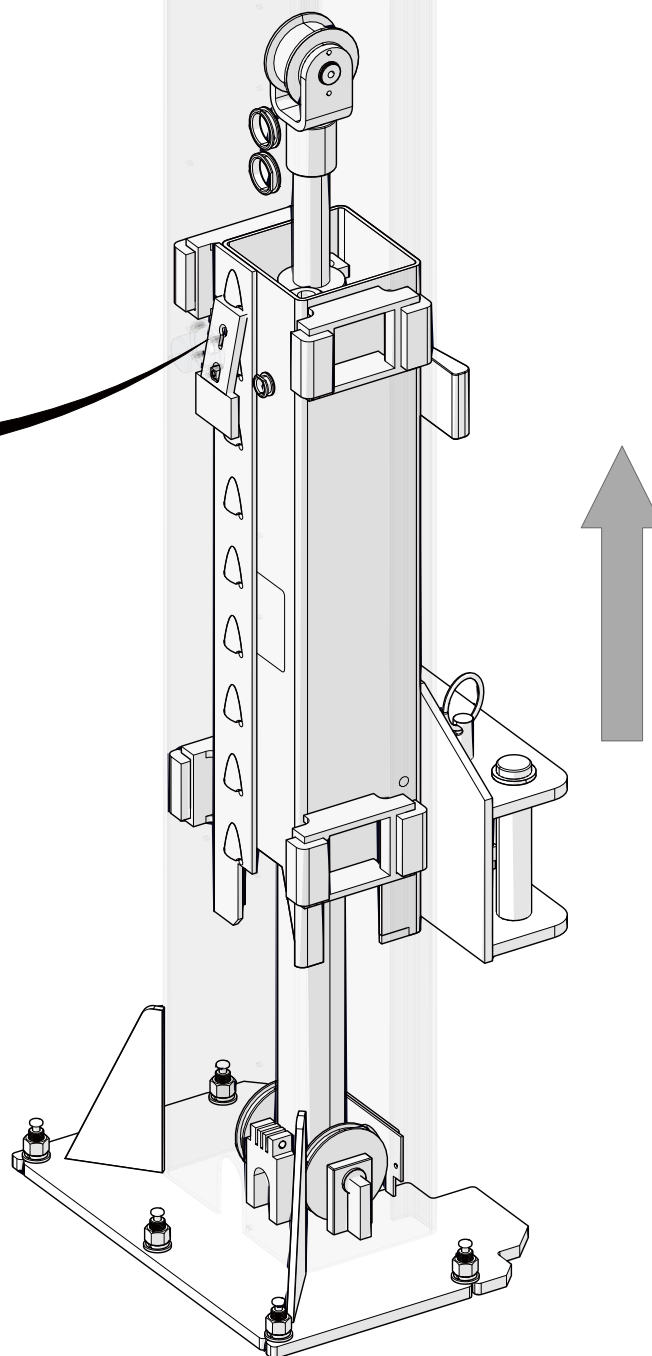
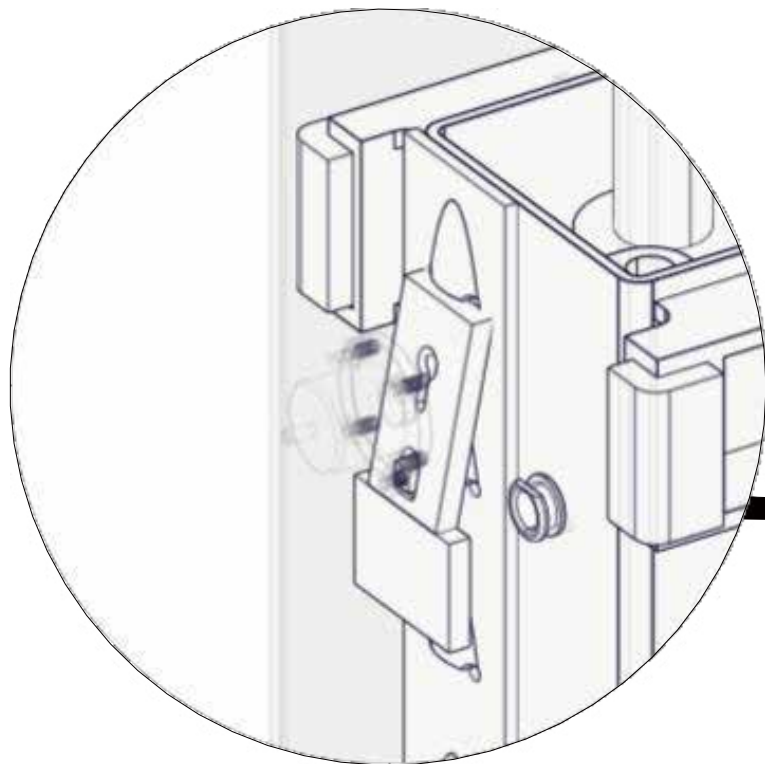

Step 8

To lift up the carriage to the first latch.

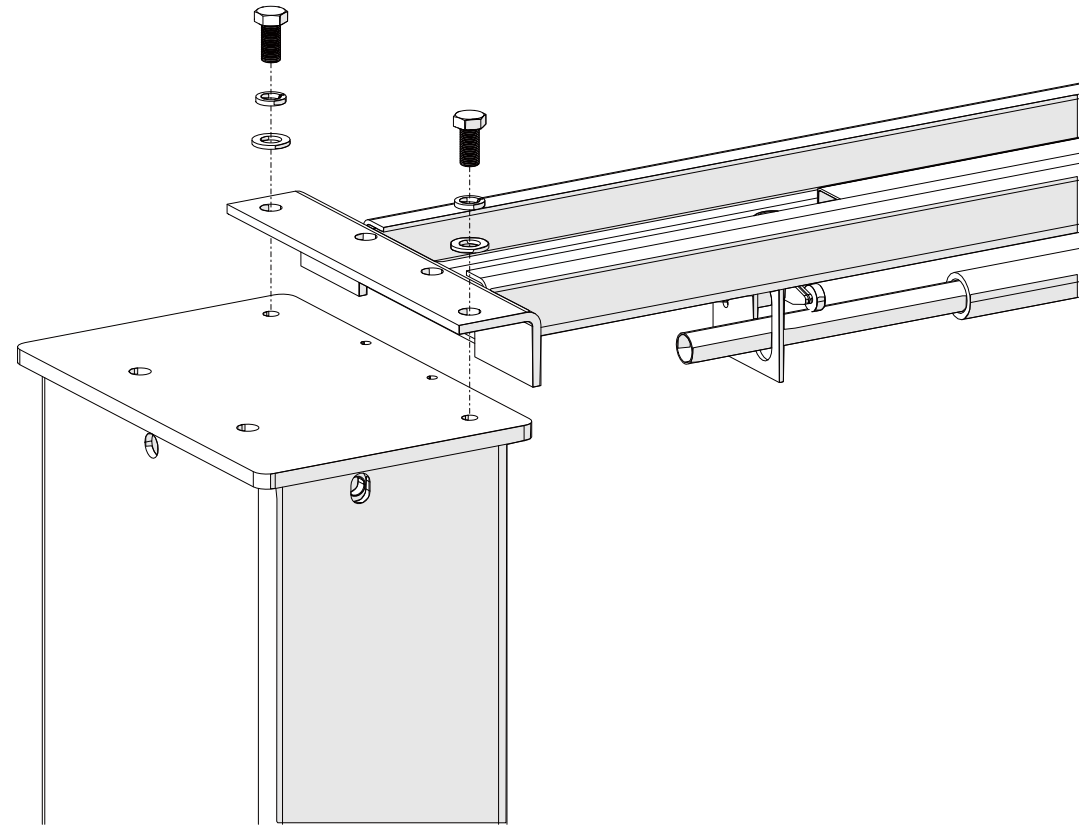
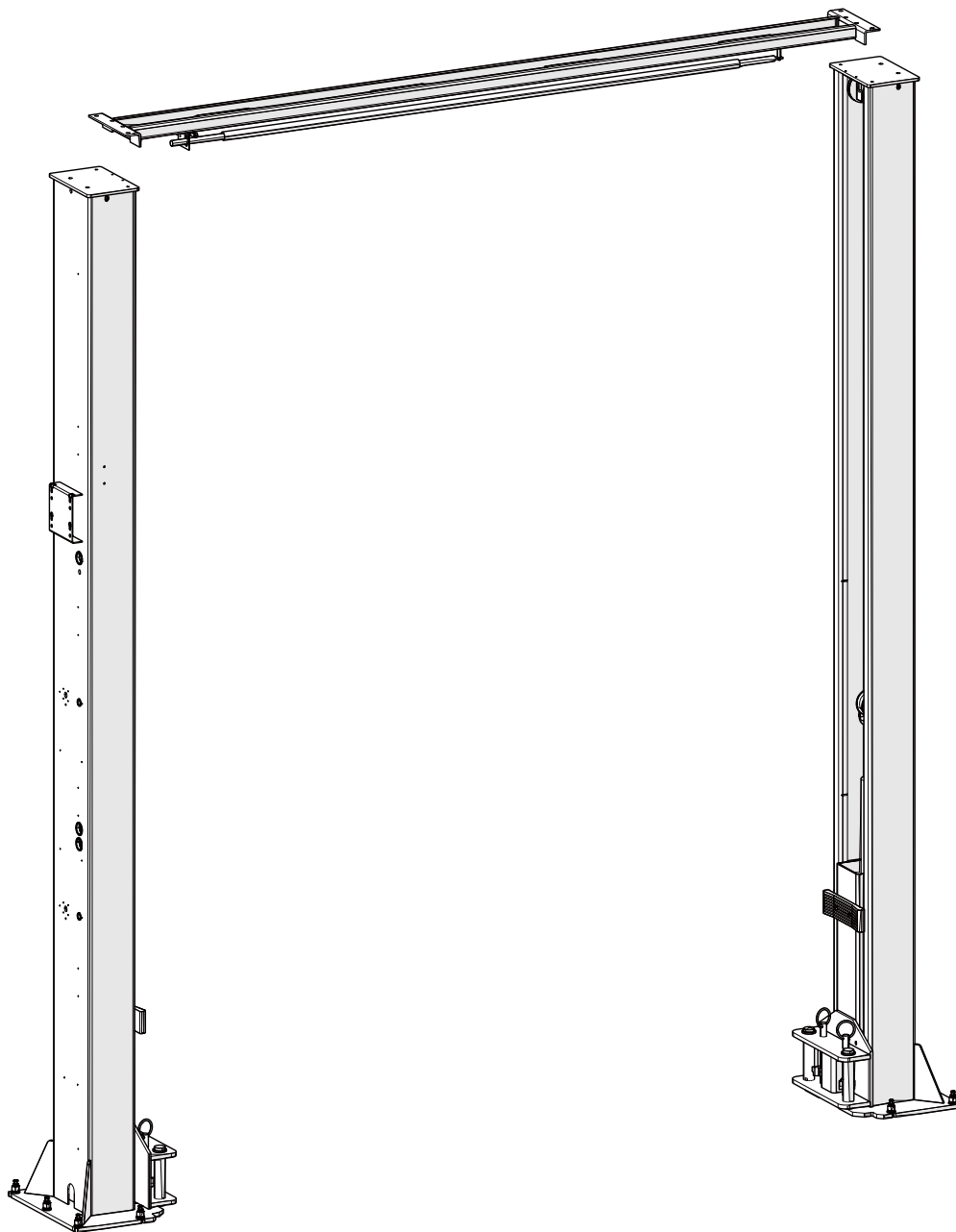

Step 9

To install top beam.

Step 10

To install synchronization cables.

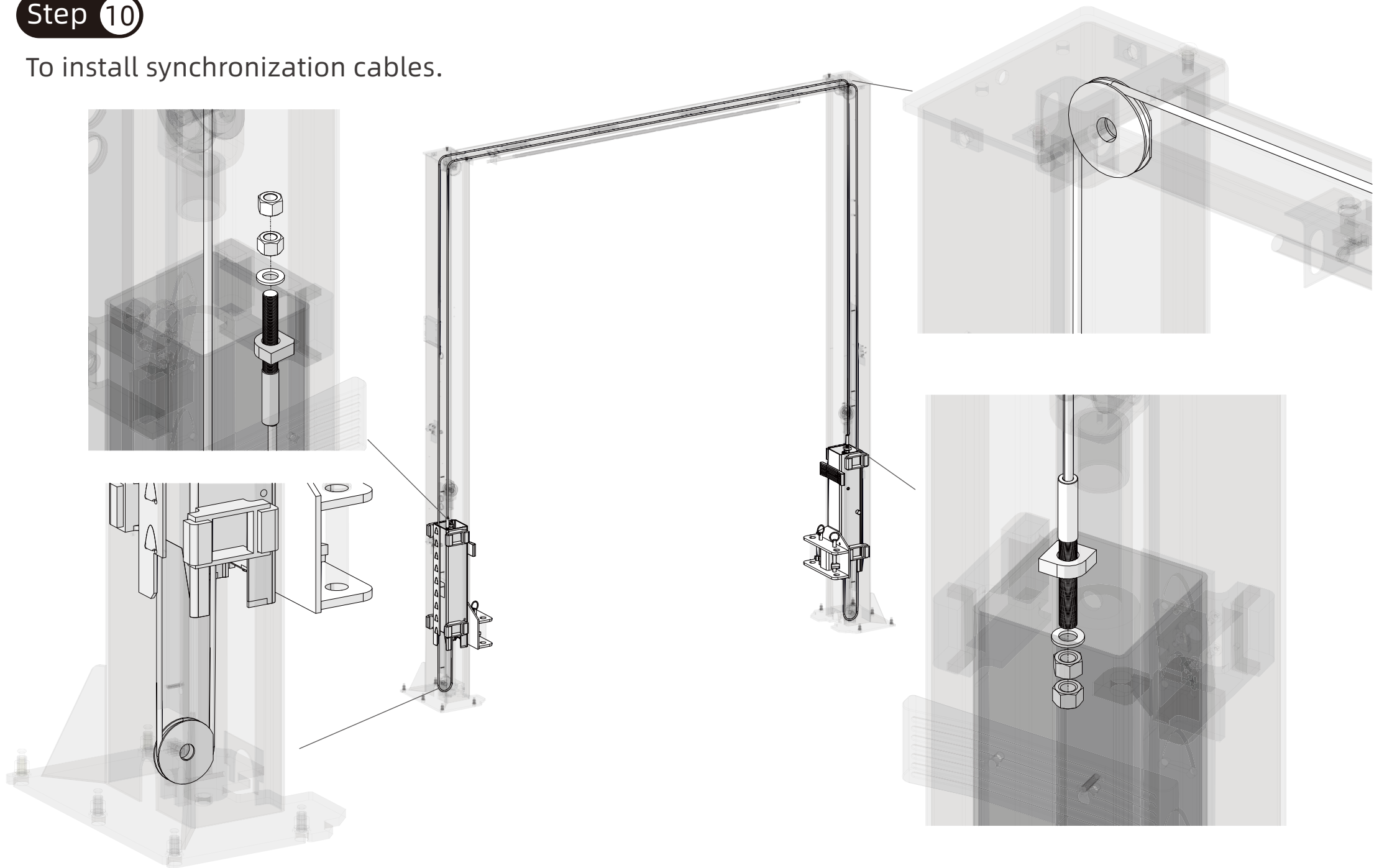

Step 11

To install power unit
and link oil hoses to two cylinders.

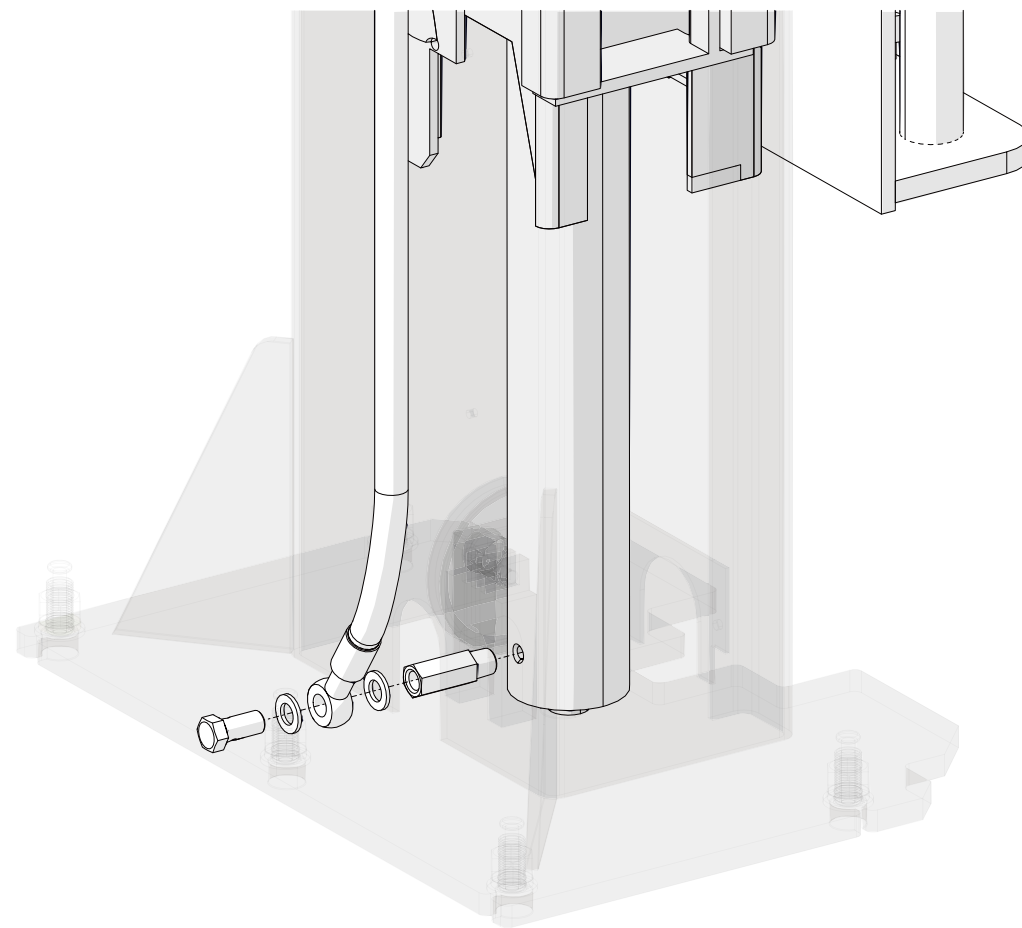
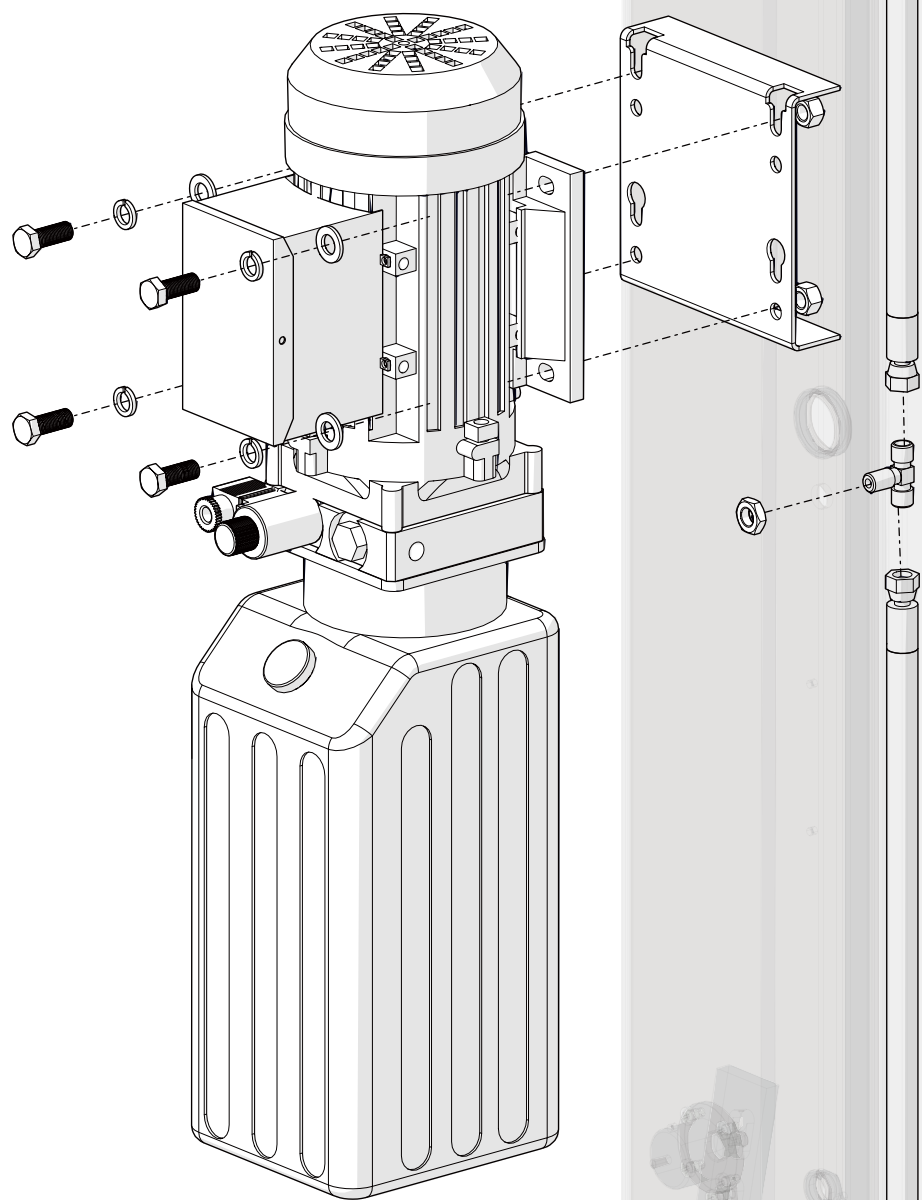

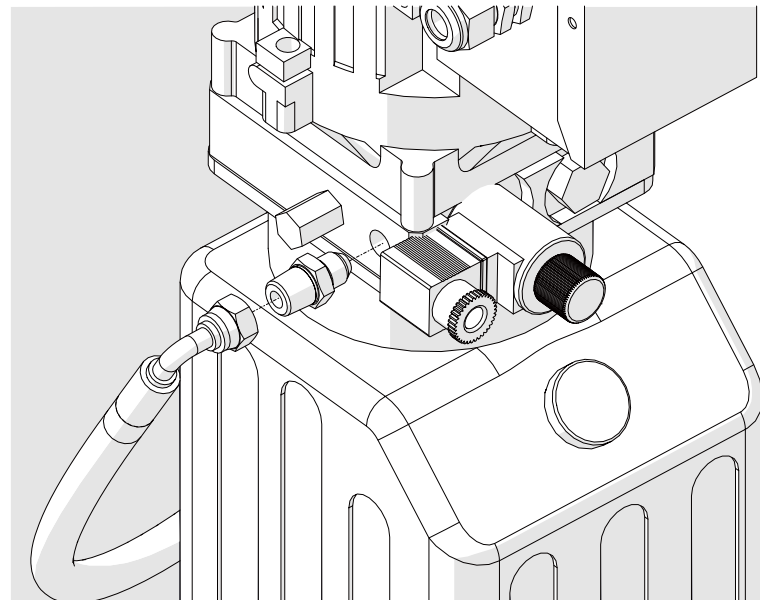
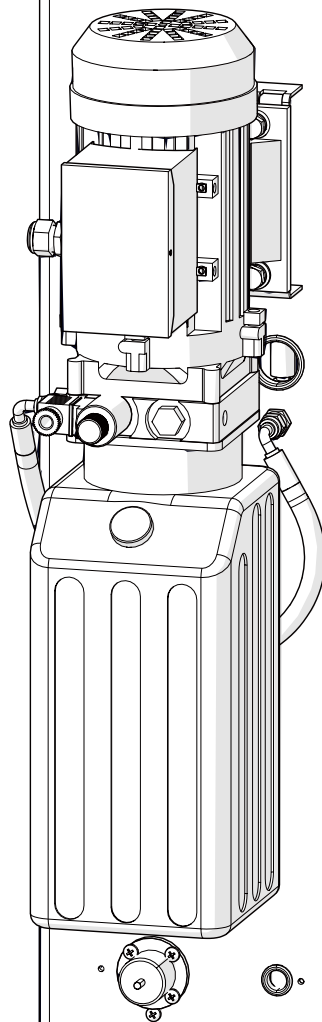
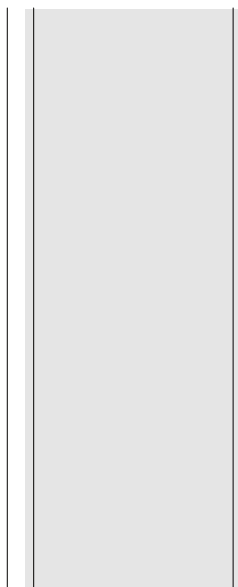
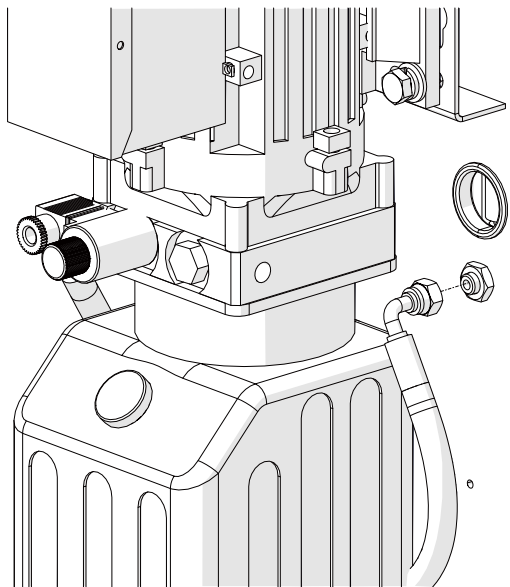

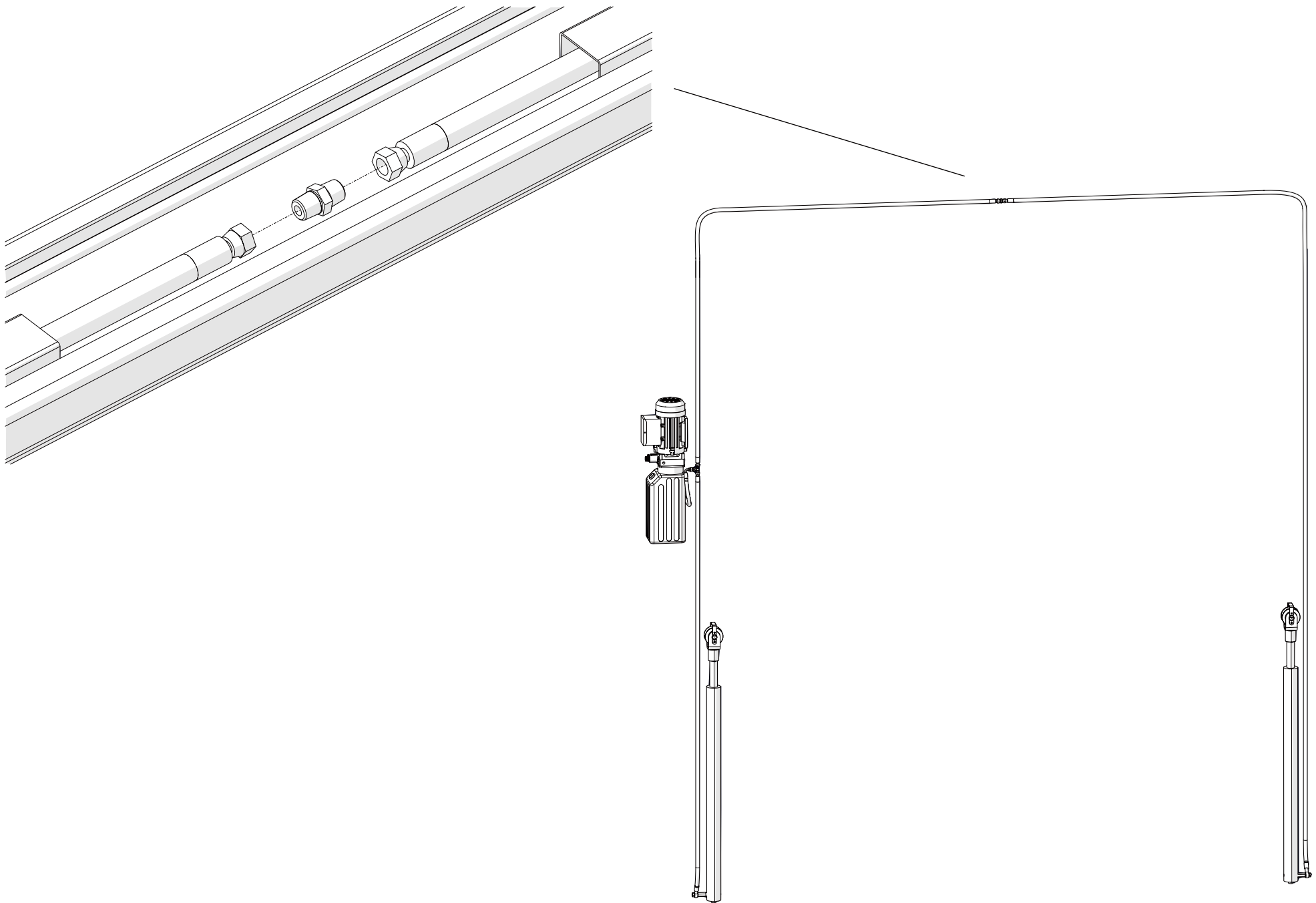

Step 12

To install control box.

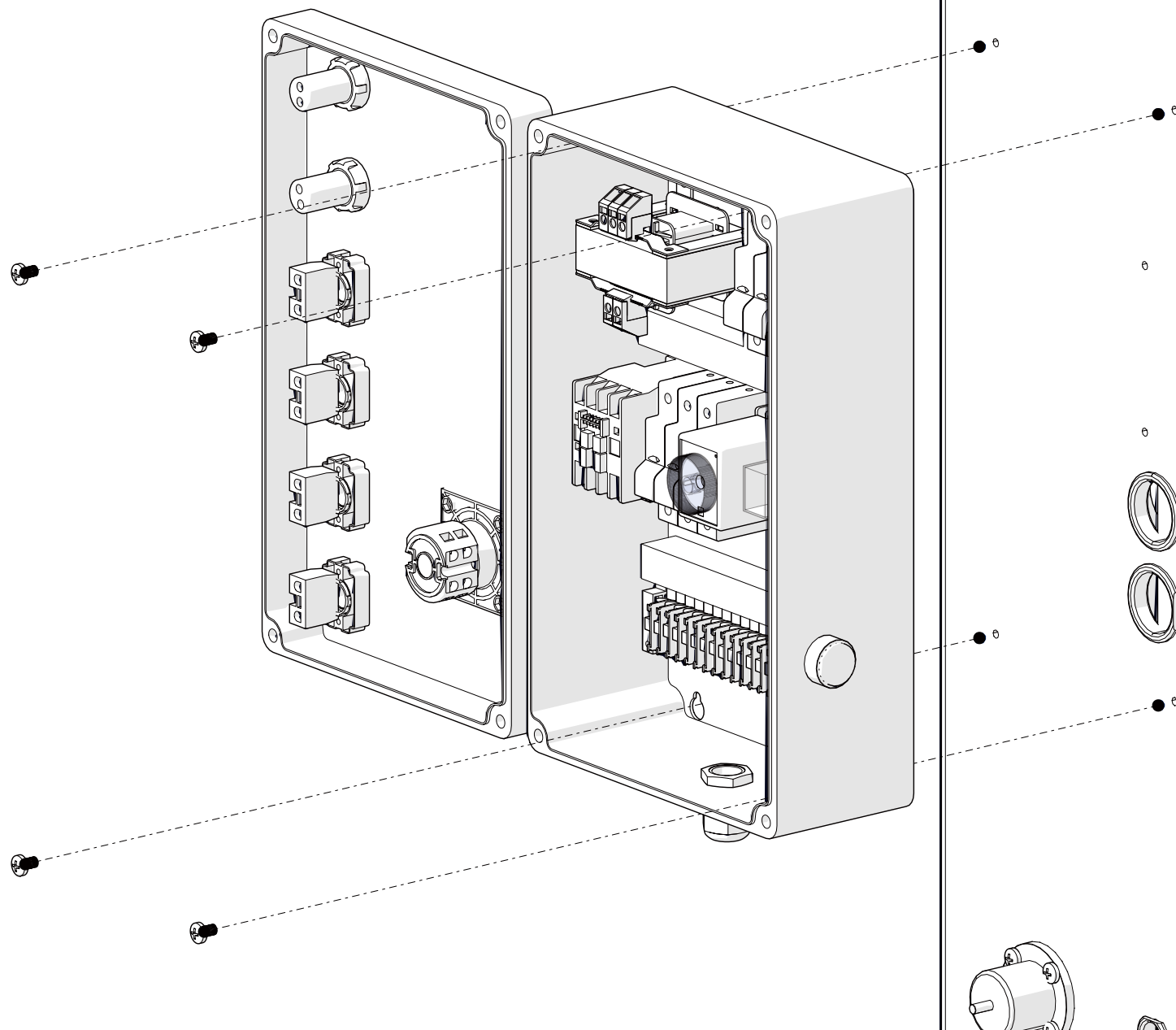

Step 13

Connect solenoid valve. No. 1 , 17

Connect electric motor. No. L1 , L2 , L3 , PE

Electric motor

Solenoid valve

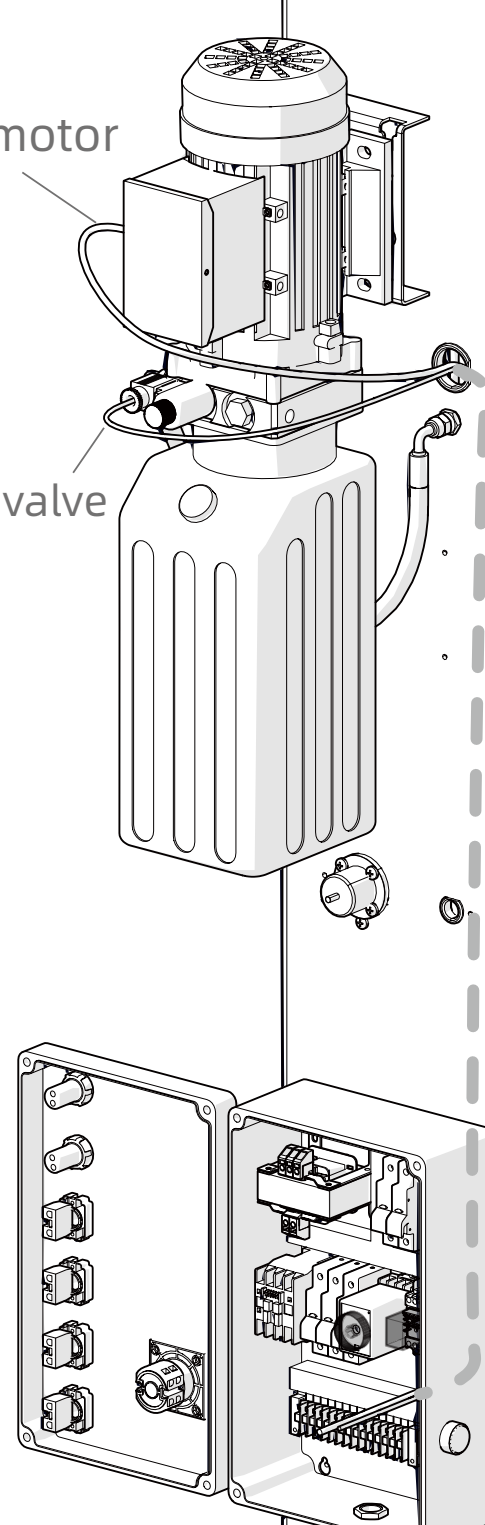

Step 14

Connect the electromagnets.

No. 1 , 16

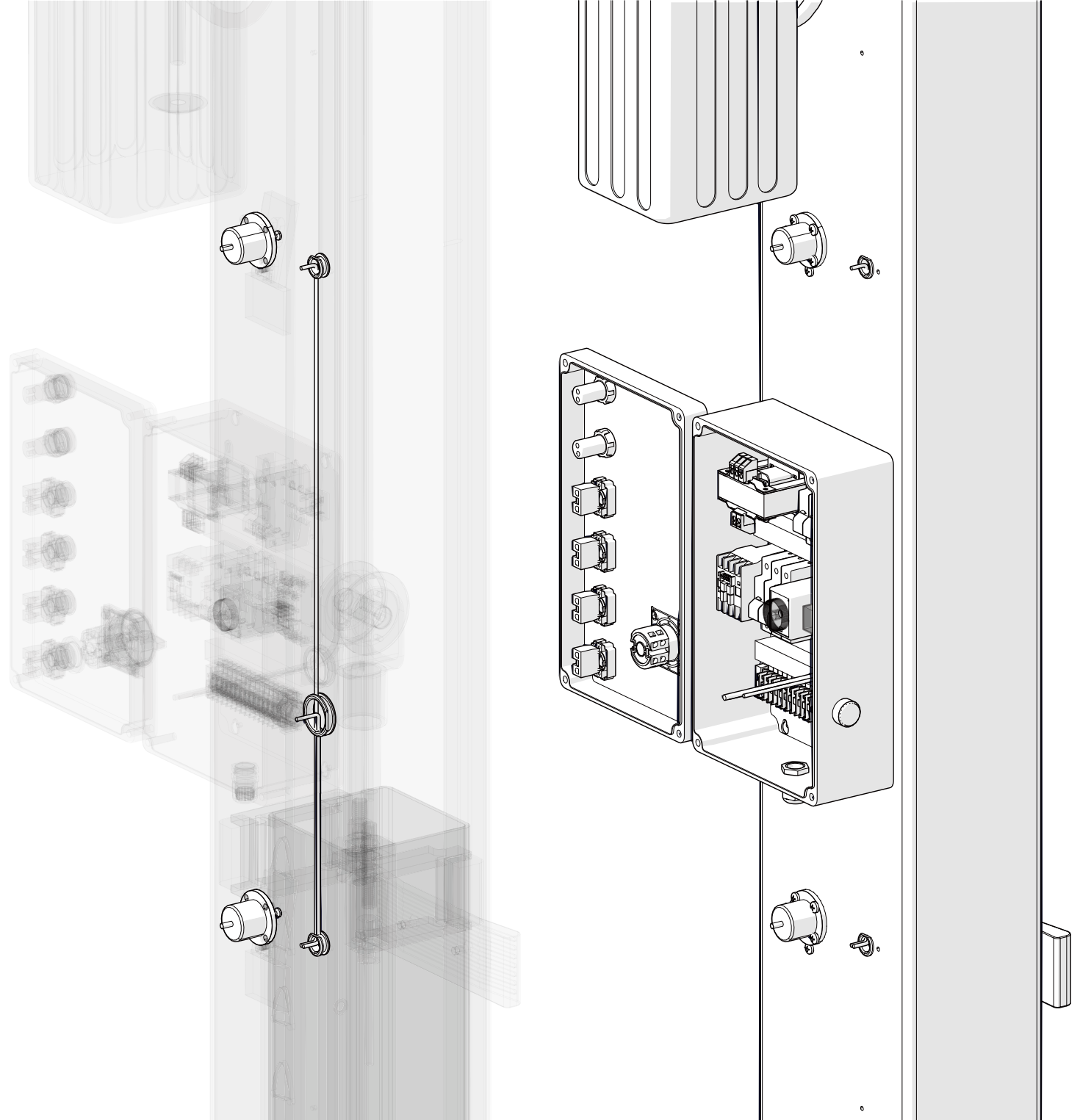
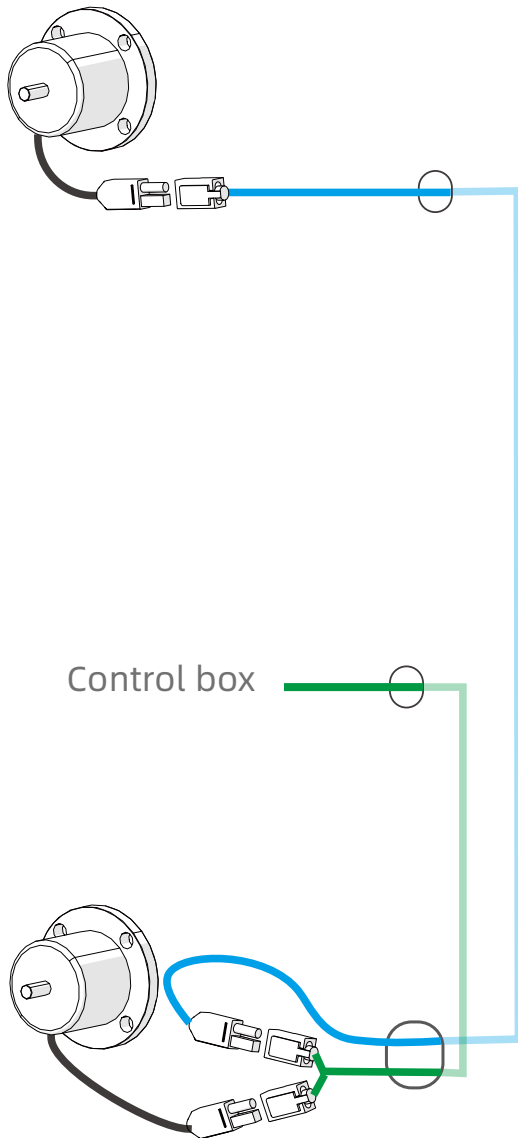

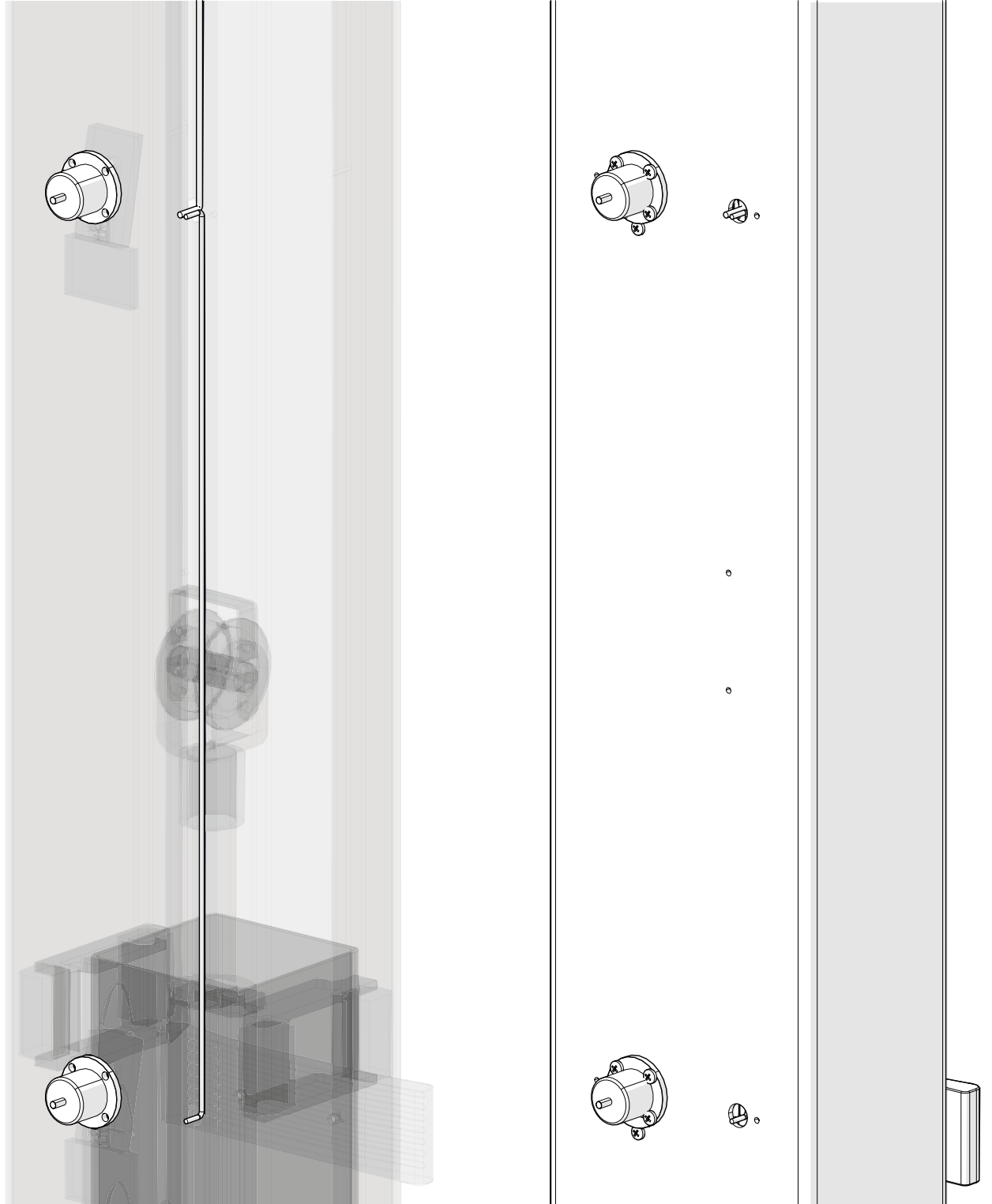
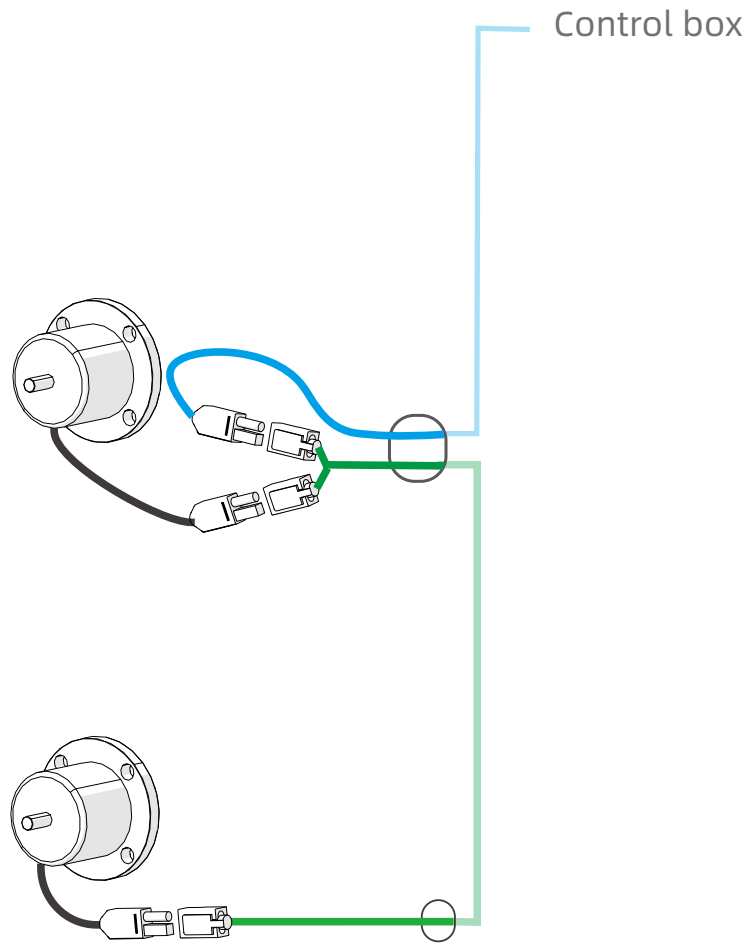

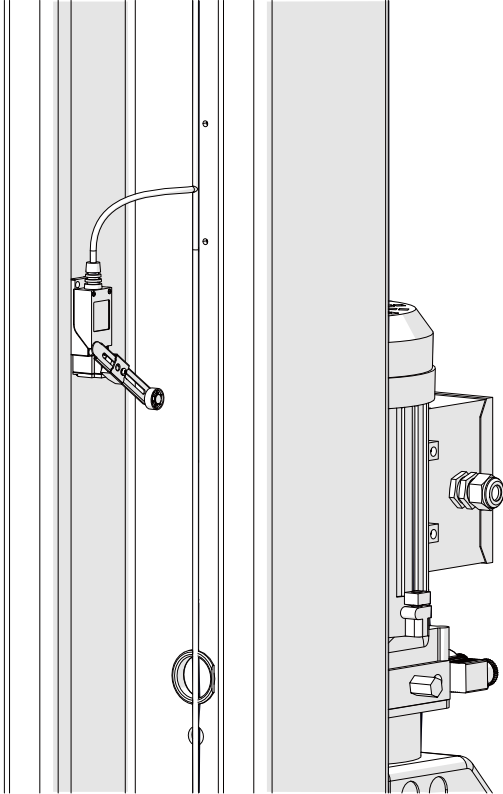

Step 15

To fix up limit switch.
Connect limit switch. No. 8 , 9 , 10

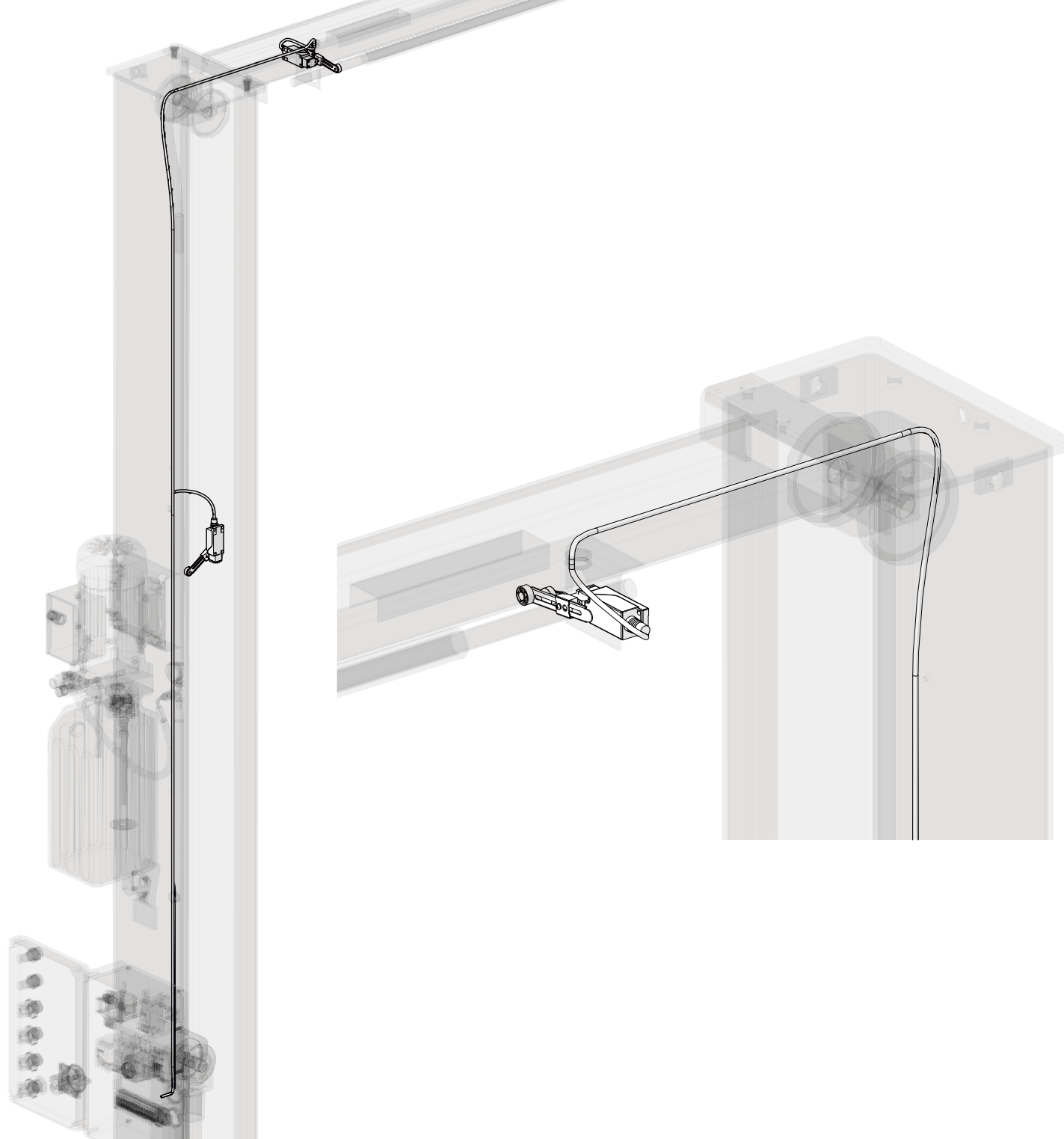

Step 16

Connect power line. No. U , V , W , PE
Fill with hydraulic oil, Test electric
system and hydraulic system.

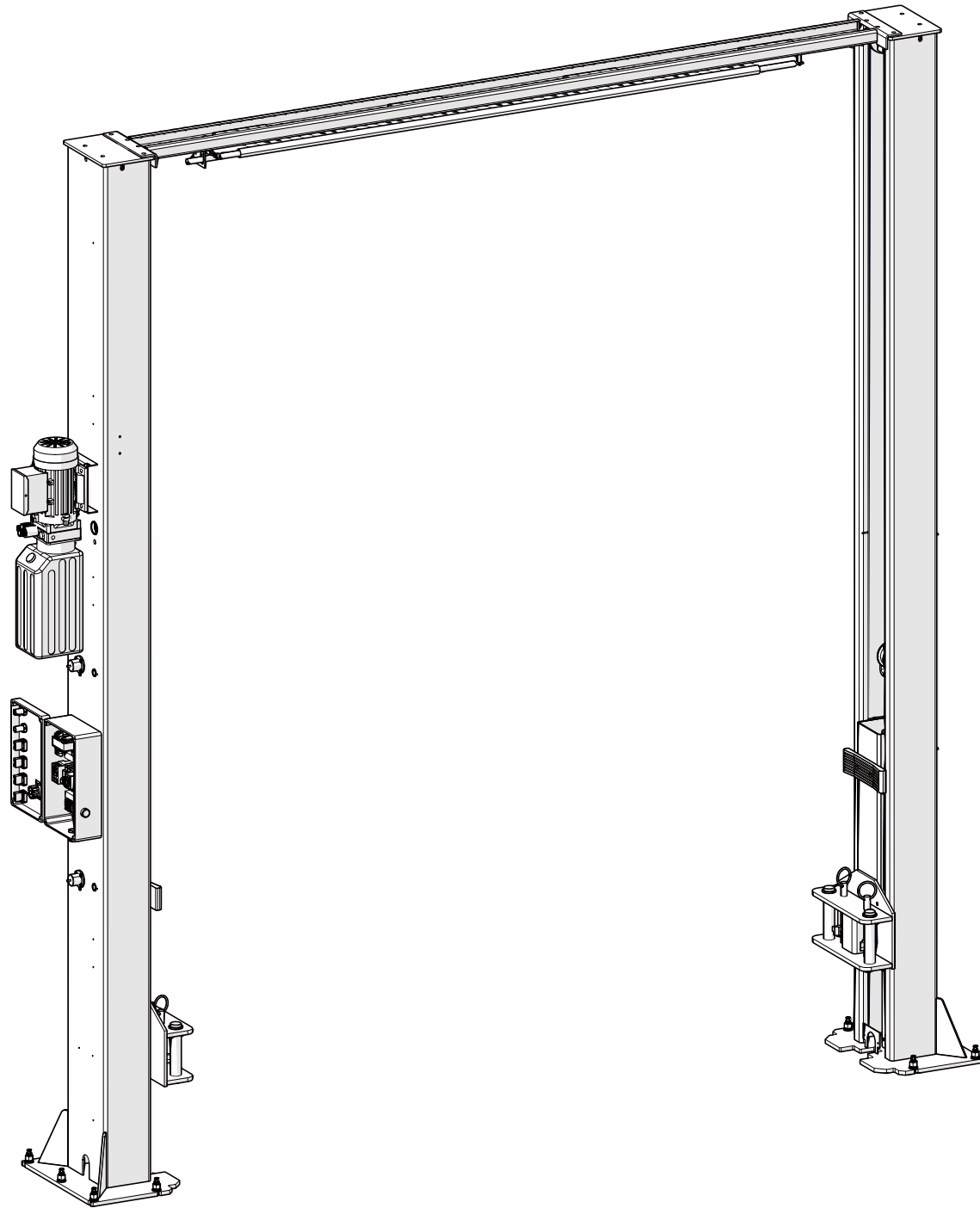

Step 17

To install oil , wire cover.

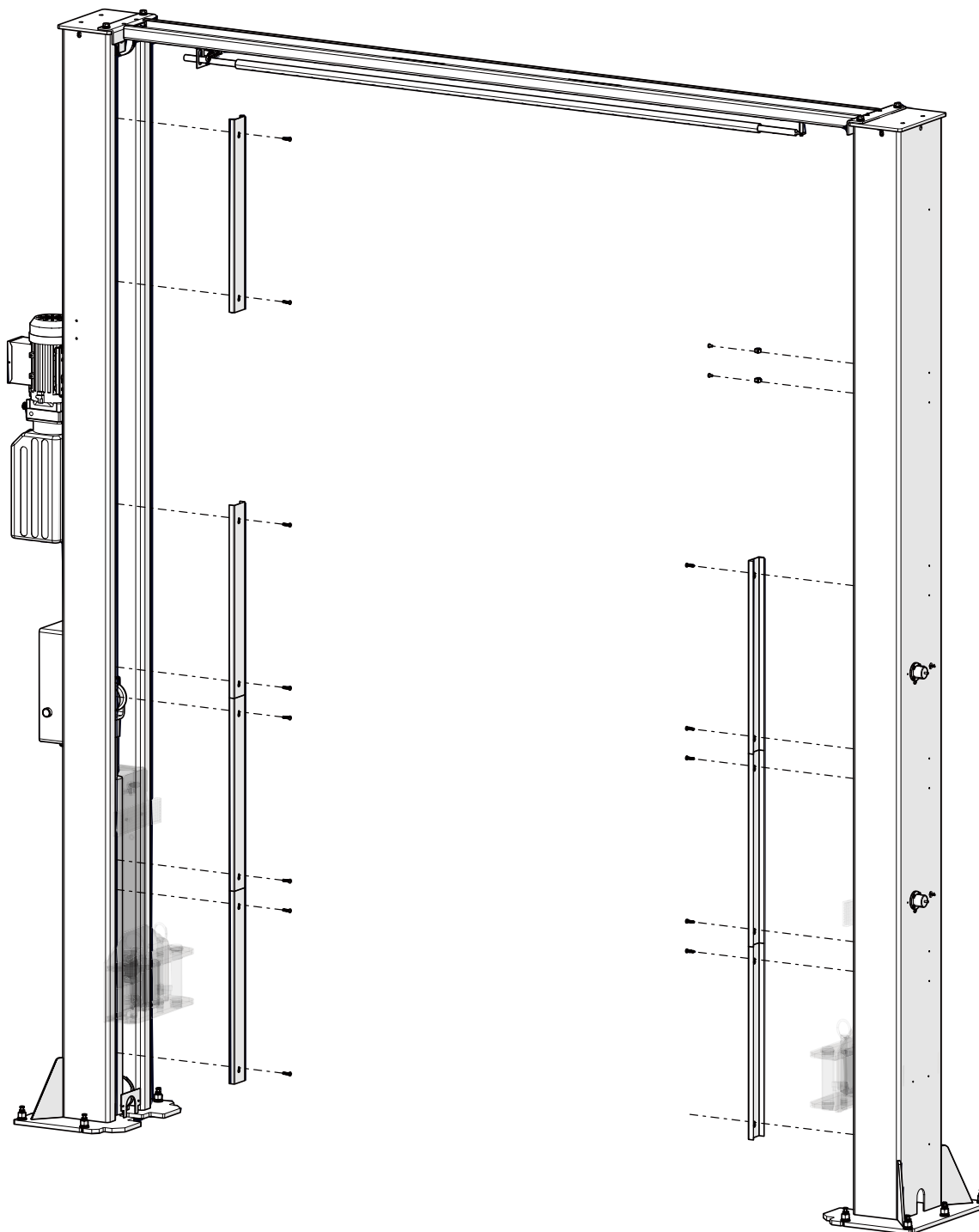

Step 18

To install arms and foot protector.

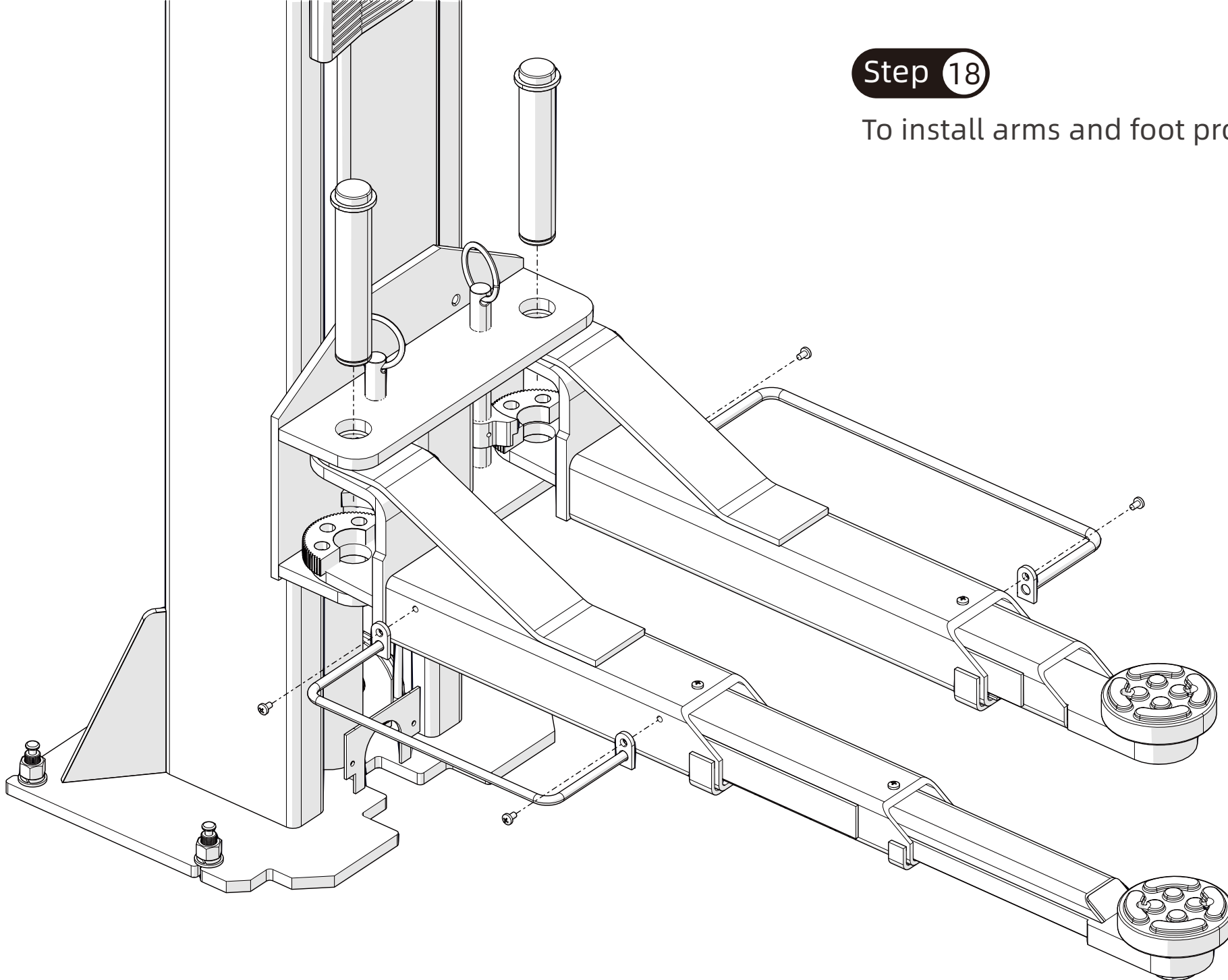

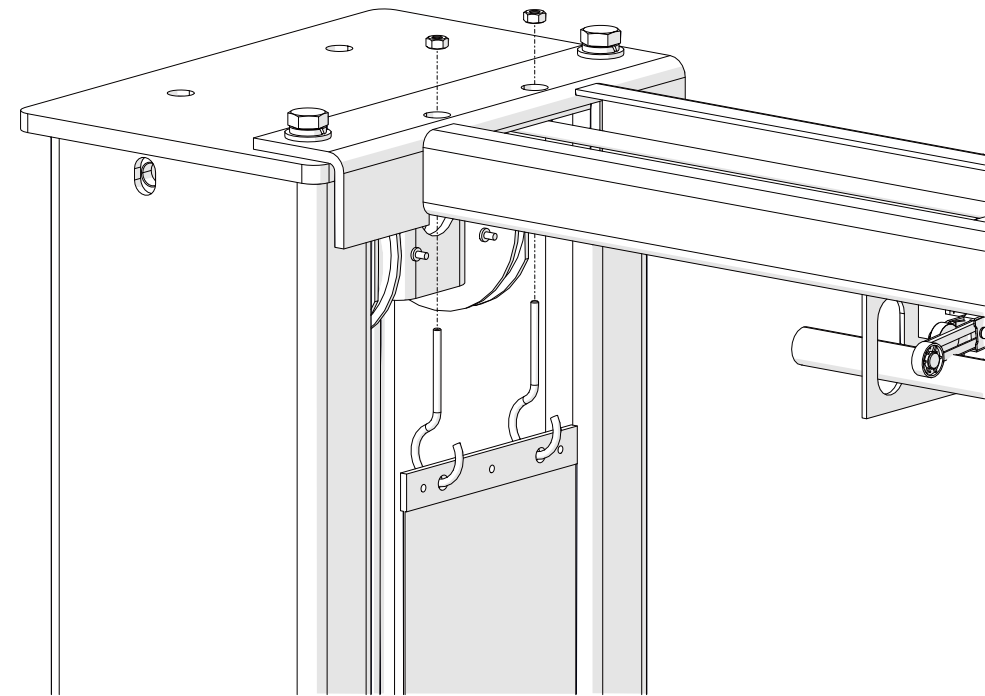
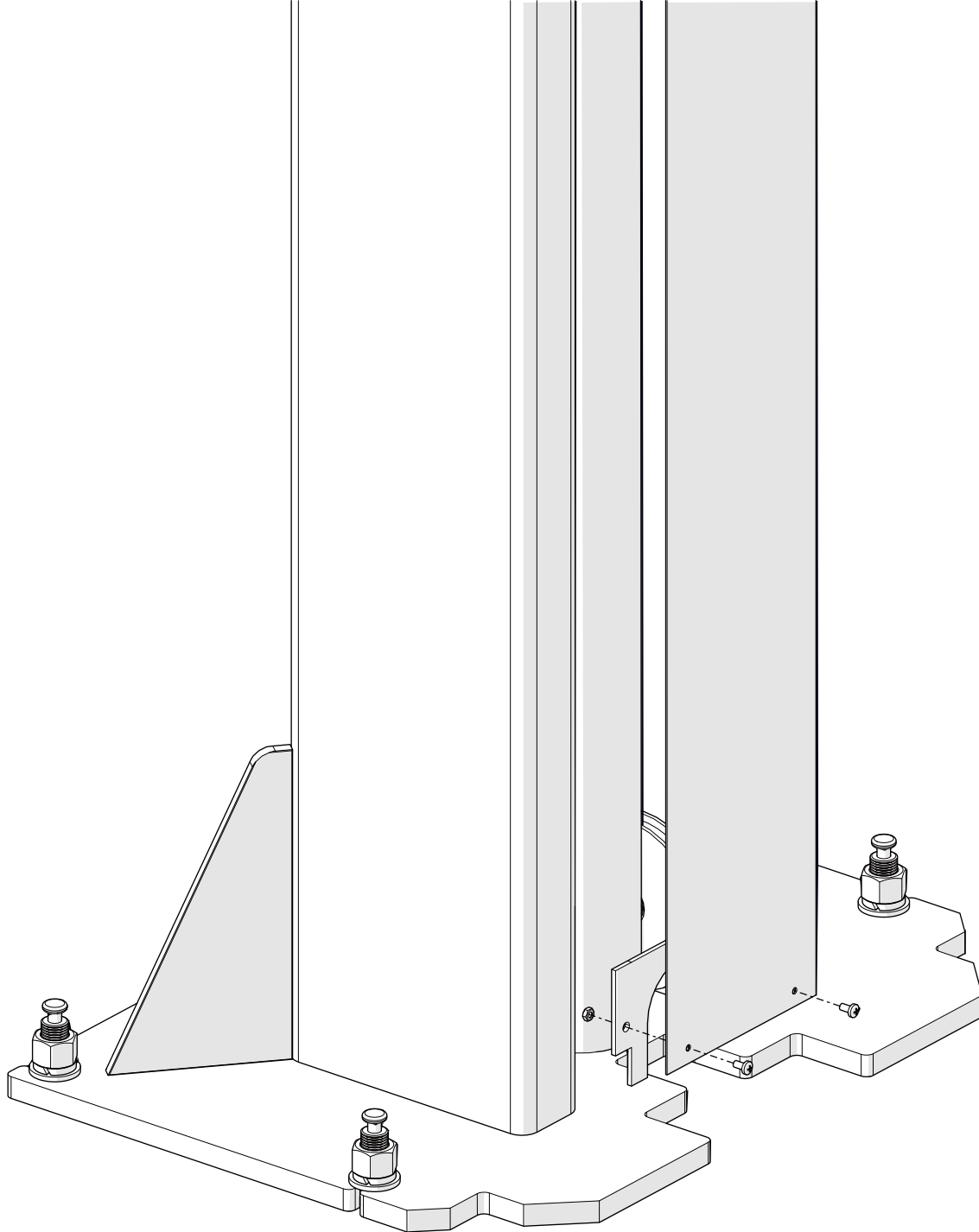

Step 19

To install column curtain.

Step 20

To install electromagnets cover and SUV adapter bracket.

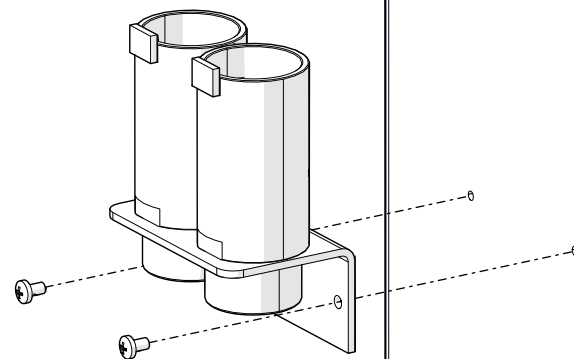
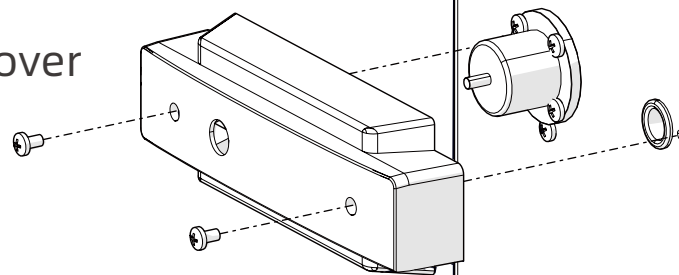

EPLU STM